

CERTIFICATE OF LOCATION OF GOVERNMENT CORNER

County of Anoka

State of Minnesota

East 1/4 Corner of Sec. 32 Township 32 Range 23

On the 17th day of April, 1963, the described corner was evidenced by a 3/4" iron pipe

and to perpetuate the location of said corner, at the exact location thereof, a permanent marker was placed consisting of a cast iron monument

AND on the 6th day of April, 2021, said permanent marker was found and the ties were updated

Updated reference ties are as shown below.

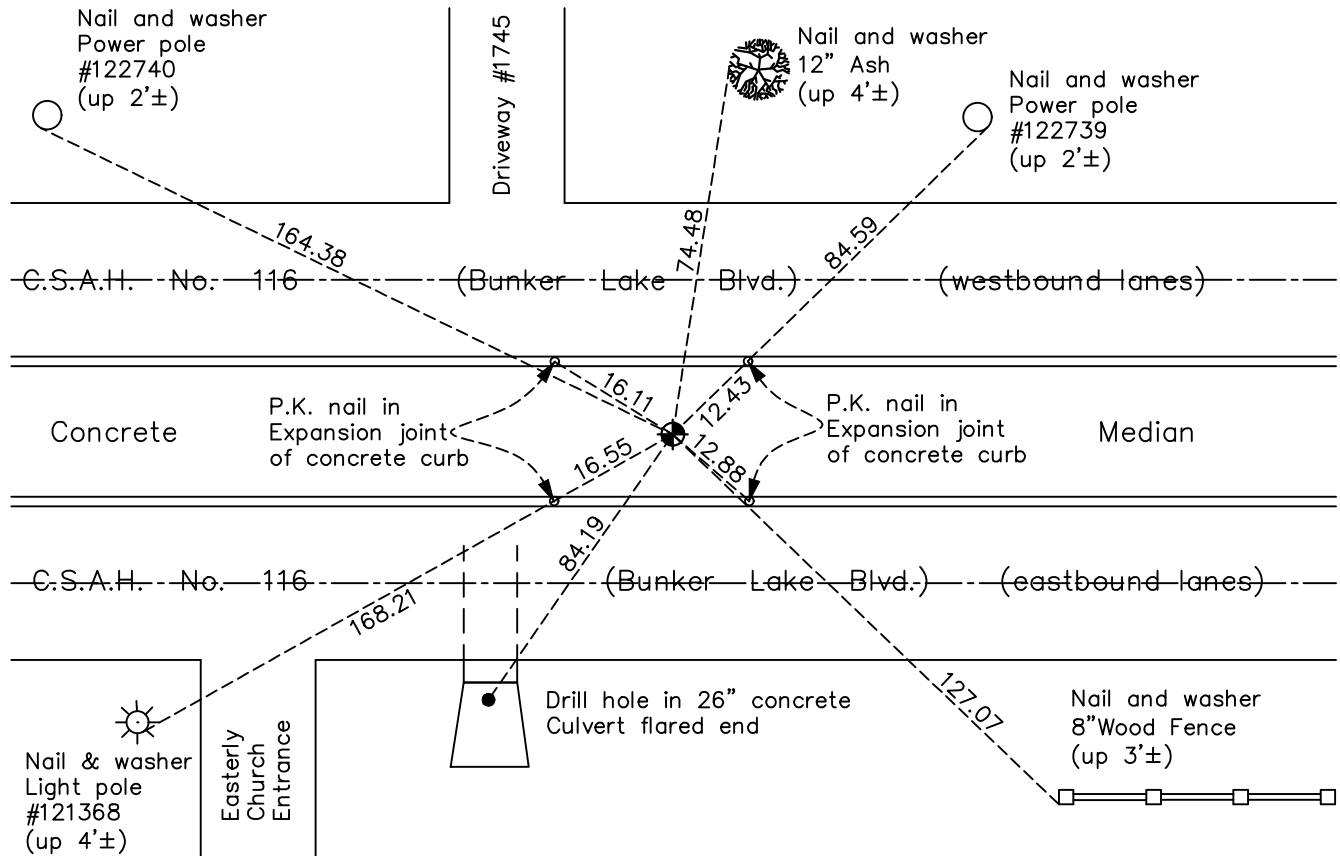

Revision Date
7/27/2021

N.A.D. 1983 Coordinates
 (1996 Adjustment)

County Project Coordinates	
Northing	166940.5681
Easting	510918.3169
Date	12/20/01

I hereby certify that this United States public land survey monument record is correct and complete to the best of my knowledge and belief.

David Zieglmeier Date 7/21/22

David Zieglmeier Anoka County Surveyor
 Minnesota License Number 46179

HISTORY OF GOVERNMENT CORNER

Page No. 124

County of Anoka

State of Minnesota

East 1/4 Corner of Sec. 32 Township 32 Range 23

CORNER HISTORY:

February 1855 - This corner was established by Hiram Taylor, Deputy Surveyor. Taylor marked the position by "Set quarter section post" with one bearing tree marked as an accessory.

June 16, 1961 - R.M. Knudsen found an iron down 1'± and updated the ties.

April 17, 1963 - Found 3/4" iron pipe down 3'± using Knudsen ties. Set cast iron monument down 0.3'± from the surface. Updated ties.

June 9, 1964 - Reset cast iron monument. Set P.K. nails 2' north and east.

July 9, 1964 - Found cast iron monument and updated ties.

August 5, 1966 - Found cast iron monument and updated ties.

May 5, 1971 - Found cast iron monument and updated ties.

June 16, 1975 - Found cast iron monument and updated ties.

June 20, 1978 - Found cast iron monument and updated ties.

June 27, 1984 - Found cast iron monument and updated ties.

November 26, 1991 - Found cast iron monument and updated ties.

August 6, 1996 - Found cast iron monument and updated ties.

December 20, 2001 - Established NAD 1983 (1996 adj.) Anoka County project coordinates by static GPS methods.

April 6, 2011 - Found cast iron monument missing and all corner ties gone. Set temporary position using VRS GPS methods.

May 13, 2011 - Found broken cast iron monument and removed. Set cast iron monument in concrete median after road construction using static GPS methods. Updated ties.

January 6, 2017 - Found cast iron monument. Verified position by VRS GPS methods. Updated ties.

April 6, 2021 - Found cast iron monument. Updated ties.