

# CERTIFICATE OF LOCATION OF GOVERNMENT CORNER

County of Anoka

State of Minnesota

## East 1/4 Corner of Sec. 34 Township 32 Range 23

On the 31st day of August, 1972, the described corner was evidenced by area resurvey

and to perpetuate the location of said corner, at the exact location thereof, a permanent marker was placed consisting of a red and white iron pipe

AND on the 16th day of April, 2021, said permanent marker was found and the ties  
were updated

Updated reference ties are as shown below.

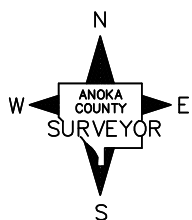
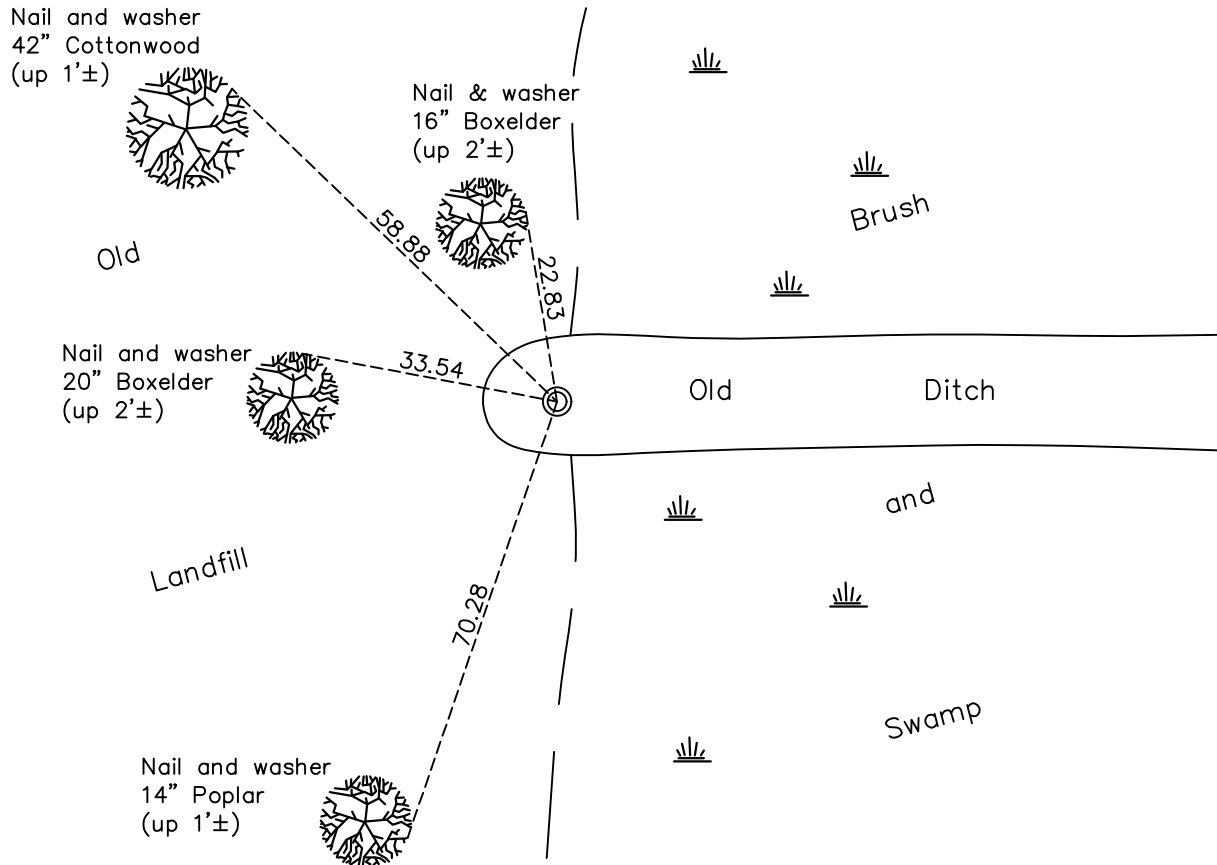

Revision Date  
7/27/2021

N.A.D. 1983 Coordinates  
 (1996 Adjustment)

County Project Coordinates	
Northing	<u>166860.9053</u>
Easting	<u>521499.6614</u>
Date	<u>2/12/02</u>

I hereby certify that this United States public land survey monument record is correct and complete to the best of my knowledge and belief.  
*David Zieglmeier* Date 7/21/22  
 David Zieglmeier Anoka County Surveyor  
 Minnesota License Number 46179

# HISTORY OF GOVERNMENT CORNER

Page No. 127

County of Anoka

State of Minnesota

East 1/4 Corner of Sec. 34 Township 32 Range 23

## **CORNER HISTORY:**

February 1855 - This corner was established by Hiram Taylor, Deputy Surveyor. Taylor marked the position by "Set quarter section post" with one bearing tree marked as an accessory.

August 31, 1972 - Set red and white iron pipe in ditch. Corner ties unavailable.

January 12, 1978 - Found red and white iron pipe set in 1972, up 3.5'±. Established ties to pipe.

July 12, 1984 - Found red and white iron pipe and updated ties.

July 1, 1987 - Found red and white iron pipe and updated ties.

August 23, 1996 - Found red and white iron pipe and updated ties.

February 12, 2002 - Found red and white iron pipe and updated ties. Established NAD 1983 (1996 adj.) Anoka County project coordinates by static GPS methods.

March 21, 2011 - Found red and white iron pipe and updated ties.

March 20, 2017 - Found red and white iron pipe and updated ties.

April 16, 2021 - Found red and white iron pipe and updated ties.