

Lino

CERTIFICATE OF LOCATION OF GOVERNMENT CORNER

County of Anoka State of Minnesota

Center Corner of Sec. 31 Township 31 Range 22

I hereby certify that on the 4th day of September, 1968, I found the described corner which was evidenced by ties by C. O. Georgi

and I further certify that to perpetuate the location of said corner, I did, at the exact location thereof, place a permanent marker consisting of a 2 1/2" iron pipe

which reference or witness monuments are located in the manner following:

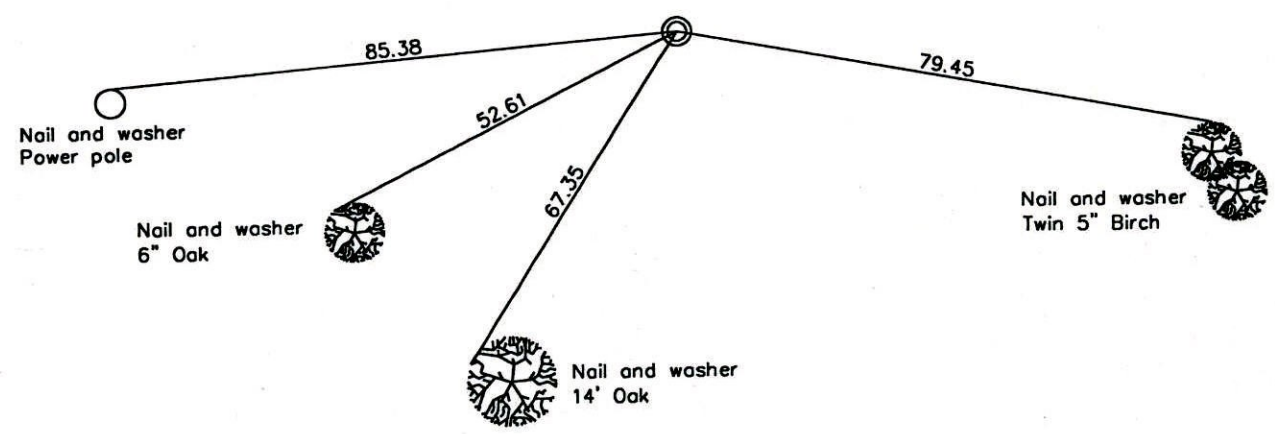
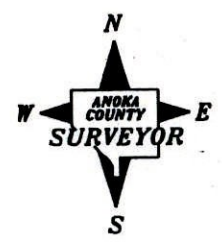

Revised date

11/5/90

N.A.D. 1983 Co-ordinates

County Project Co-ordinates	State Plane Co-ordinates
Northing _____	Y _____
Easting _____	X _____

Date _____

Center Sec. 31-T31-R22

Found $2\frac{1}{2}$ " Iron Pipe down $0.6\pm$ with $\frac{3}{4}$ "
Pinched Iron Pipe in center. Found from
ties by C.O. Georgi.

September 4, 1968
D. Powell
R. Olson

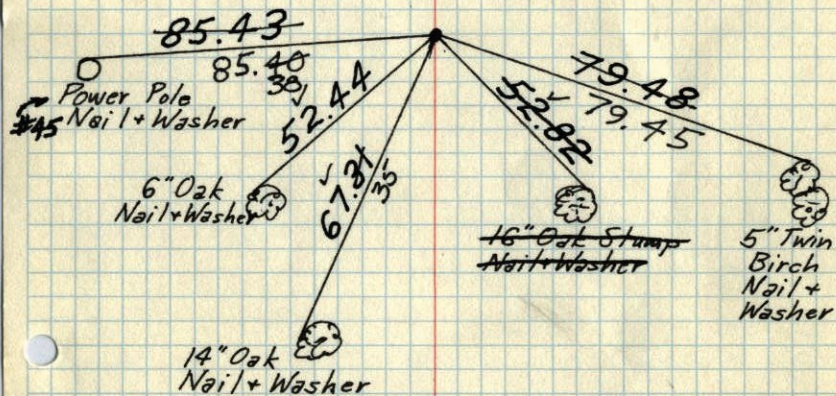

TIE CHECK
8-12-80
B. STEPHENS
P. ROSS
P. HORNBY

TIE CHECK
JUNE 6, 1977
R. SANNEBUD
D. BRIEN
J. STEPHENS

Tie Check
July 11, 1973
B. Olson
D. Brien
D. Farmer

TEMPERATURE CORRECTED
AND HORIZONTALLY
TAPED MEASUREMENTS