

CERTIFICATE OF LOCATION OF GOVERNMENT CORNER

County of Anoka

State of Minnesota

Northwest Corner of Sec. 2 Township 33 Range 22

On the 30th day of December, 1975, the described corner was evidenced by area resurvey

and to perpetuate the location of said corner, at the exact location thereof, a permanent marker was placed consisting of 2" red and white iron pipe

AND on the 2nd day of March, 2022, said permanent marker was found with a sign attached facing east and the ties were updated

Updated reference ties are as shown below.

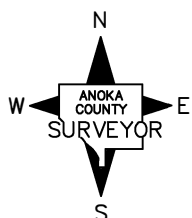
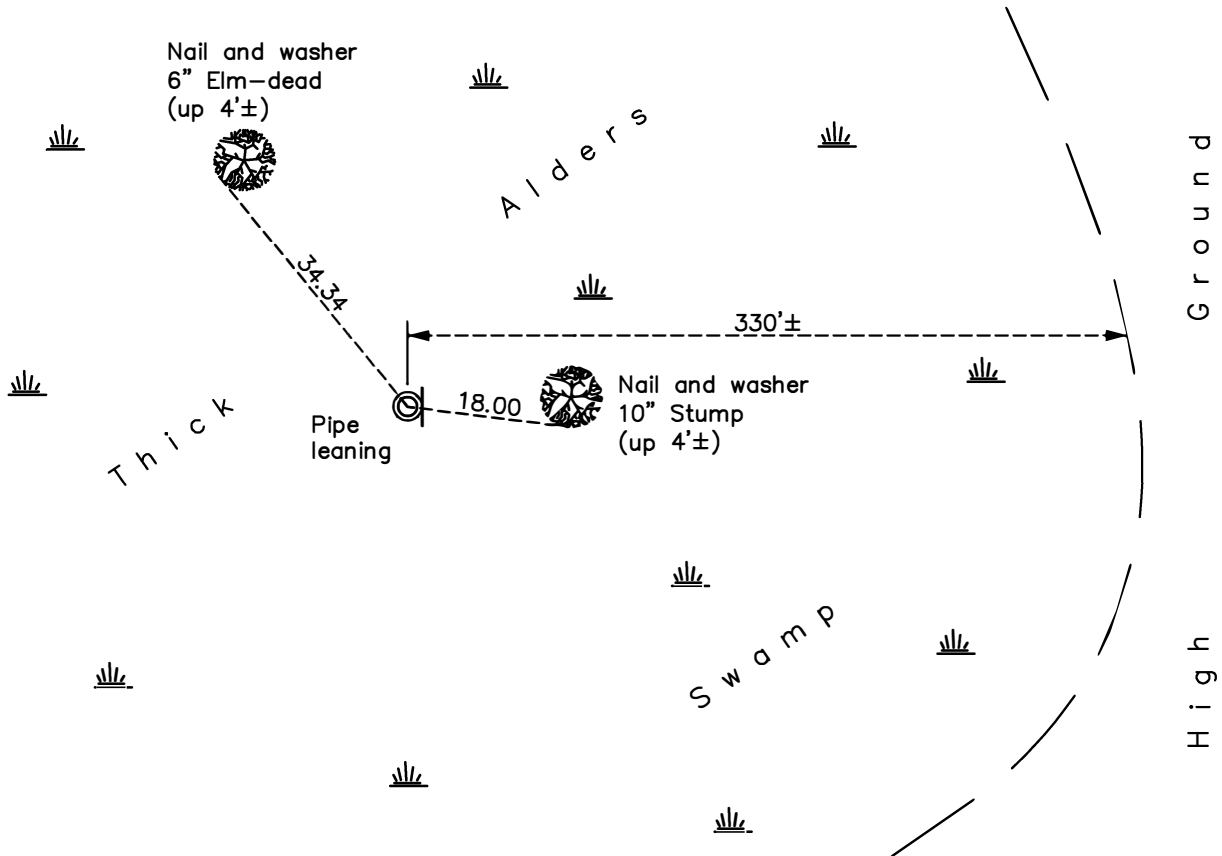

Revision Date
03/16/22

N.A.D. 1983 Coordinates
 (1996 Adjustment)

County Project Coordinates	
Northing	<u>227051.0423</u>
Easting	<u>553205.3710</u>
Date	<u>2/23/05</u>

I hereby certify that this United States public land survey monument record is correct and complete to the best of my knowledge and belief.
David Zieglsmeier Date 12/11/23
 David M. Zieglsmeier, Anoka County Surveyor
 Minnesota License Number 46179

HISTORY OF GOVERNMENT CORNER

Page No. 5

County of Anoka

State of Minnesota

Northwest Corner of Sec. 2 Township 33 Range 22

CORNER HISTORY:

December 30, 1975- Area resurveyed 2" red and whit iron pipe set in wet land, ties established.

August 1, 1995 - Found red and white iron pipe and updated ties.

December 18, 2013 - Found red and white iron pipe and updated ties.

March 2, 2022 - Found red and white iron pipe, verified position by VRS GPS methods, updated ties.