

CERTIFICATE OF LOCATION OF GOVERNMENT CORNER

County of Anoka

State of Minnesota

East 1/4 Corner of Sec. 11 Township 33 Range 22

On the 17th day of January, 1975, the described corner was evidenced by area resurvey

and to perpetuate the location of said corner, at the exact location thereof, a permanent marker was placed consisting of 2" red and white iron pipe

AND on the 28th day of February, 2022, said permanent marker was found with a sign attached facing south. There were no available objects to use as ties.

Updated reference ties are as shown below.

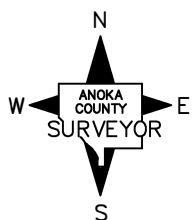
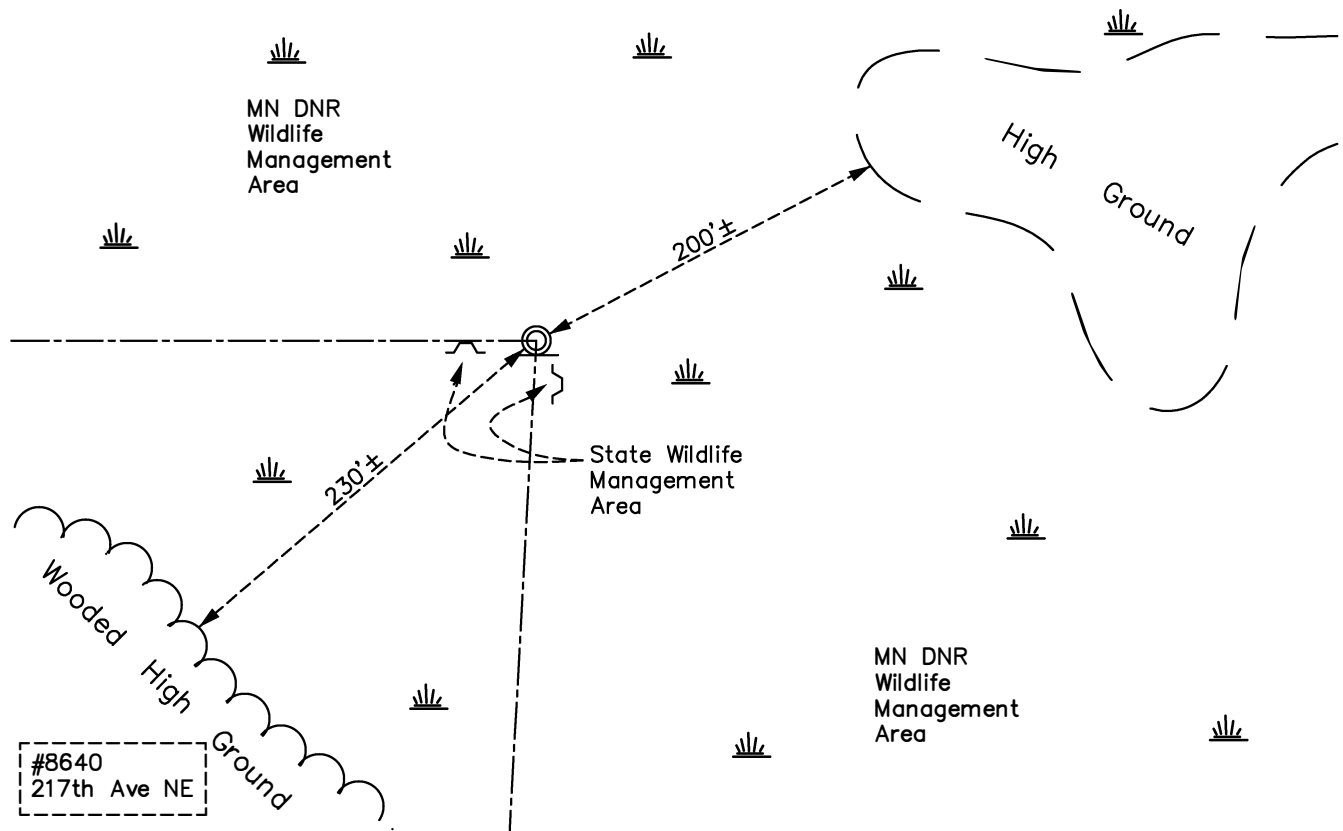

Revision Date
03/17/22

N.A.D. 1983 Coordinates
 (1996 Adjustment)

County Project Coordinates	
Northing	<u>219320.9142</u>
Easting	<u>558350.8646</u>
Date	<u>3/23/05</u>

I hereby certify that this United States public land survey monument record is correct and complete to the best of my knowledge and belief.

David Zieglmeier Date 12/11/23

David M. Zieglmeier, Anoka County Surveyor
 Minnesota License Number 46179

HISTORY OF GOVERNMENT CORNER

County of Anoka

State of Minnesota

East 1/4 Corner of Sec. 11 Township 33 Range 22

CORNER HISTORY:

January 17, 1975 - Set red and white pipe up 3'± using area resurvey. No corner ties established.

March 23, 2005 - Established NAD 1983 (1996 adj.) Anoka County project coordinates by static GPS methods.

January 2, 2014 - Found red and white iron pipe and verified position by VRS GPS methods.

February 28, 2022 - Found red and white iron pipe and verified position by VRS GPS methods.