

# CERTIFICATE OF LOCATION OF GOVERNMENT CORNER

County of Anoka

State of Minnesota

## South 1/4 Corner of Sec. 12 Township 33 Range 22

On the 28th day of January, 1974, the described corner was evidenced by a granite monument

and to perpetuate the location of said corner, at the exact location thereof, a permanent marker was placed consisting of the same granite monument

AND on the 28th day of June, 2023, said permanent marker was found granite mnomument at ground surface with sign and post on the north side and updated available ties

Updated reference ties are as shown below.

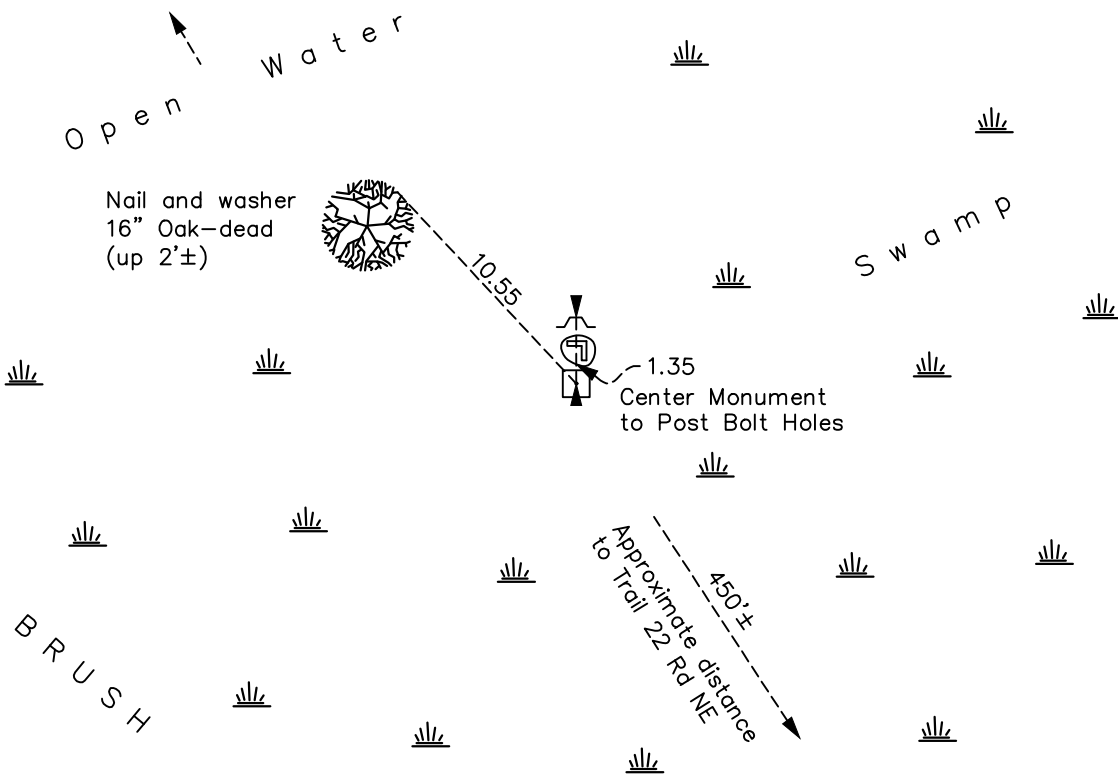

Revision Date

7/26/2023

N.A.D. 1983 Coordinates  
(1996 Adjustment)

County Project Coordinates	
Northing	<u>216579.9792</u>
Easting	<u>560902.7647</u>
Date	<u>3/22/05</u>

I hereby certify that this United States public land survey monument record is correct and complete to the best of my knowledge and belief.

David Zieglmeier Date 12/11/23

David Zieglmeier Anoka County Surveyor  
Minnesota License Number 46179

# HISTORY OF GOVERNMENT CORNER

County of Anoka

State of Minnesota

## South 1/4 Corner of Sec. 12 Township 33 Range 22

### **CORNER HISTORY:**

December 15, 1909 - Found monument and established ties to monument.

January 28, 1974 - Found granite monument and updated ties. Placed sign and post 1'± north of monument.

July 24, 1978 - Found granite monument and updated ties.

August 9, 1995 - Found granite monument and updated ties.

May 3, 1996 - Found granite monument and updated ties.

March 22, 2005 - Established NAD 1983 (1996 adj.) Anoka County project coordinates by static GPS methods.

January 13, 2014 - Found granite monument and updated ties.

March 29, 2022 - Found granite monument and verified position by VRS GPS method. Updated ties.

June 28, 2023 - Found granite monument, verified position by ACS RTK GPS method. Updated all available ties.