

CERTIFICATE OF LOCATION OF GOVERNMENT CORNER

County of Anoka

State of Minnesota

North 1/4 Corner of Sec. 15 Township 33 Range 22

On the 13th day of April, 1970, the described corner was evidenced by an iron pipe

and to perpetuate the location of said corner, at the exact location thereof, a permanent marker was placed consisting of a cast iron monument

AND on the 4th day of January, 2022, said permanent marker was found flush and the ties were updated

Updated reference ties are as shown below.

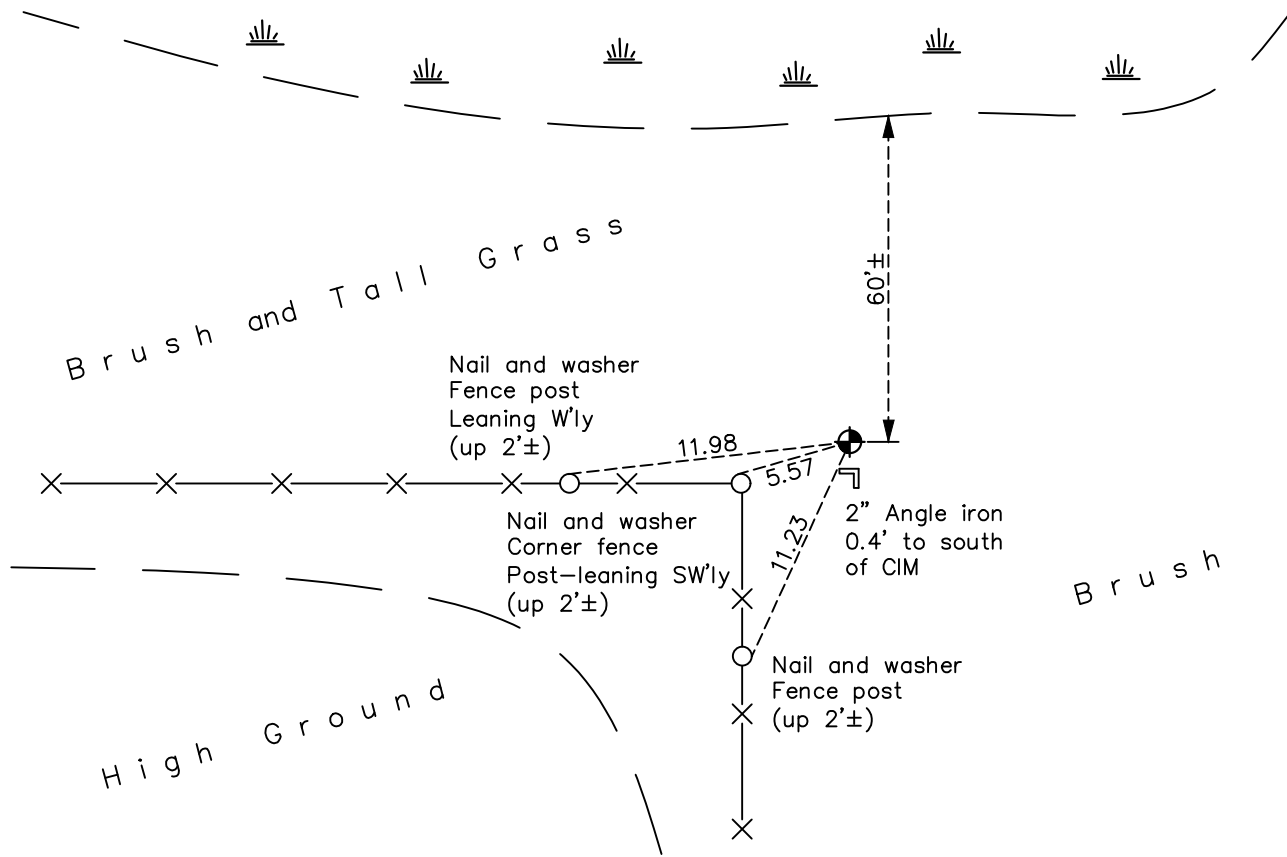

N
W ANOKA COUNTY SURVEYOR E
S

Revision Date
03/17/22

N.A.D. 1983 Coordinates
(1996 Adjustment)

| County Project Coordinates | |
|----------------------------|-------------|
| Northing | 216744.9796 |
| Easting | 550105.2452 |
| Date | 5/06/04 |

I hereby certify that this United States public land survey monument record is correct and complete to the best of my knowledge and belief.

David Zieglmeier Date 12/11/23

David M. Zieglmeier, Anoka County Surveyor
Minnesota License Number 46179

HISTORY OF GOVERNMENT CORNER

Page No. 52

County of Anoka

State of Minnesota

North 1/4 Corner of Sec. 15 Township 33 Range 22

CORNER HISTORY:

April 13, 1970 - Found iron pipe set using area resurvey by D. Hult. Verified position of iron pipe and replaced with a cast iron monument flush. Established ties to cast iron monument.

July 15, 1971 - Found cast iron monument and updated ties.

July 24, 1975 - Found cast iron monument and updated ties.

July 24, 1978 - Found cast iron monument and updated ties.

August 25, 1981 - Found cast iron monument and updated ties.

June 18, 1985 - Found cast iron monument and updated ties.

June 28, 1993 - Found cast iron monument and updated ties.

August 25, 2003 - Found cast iron monument and updated ties.

May 6, 2004 - Established NAD 1983 (1996 adj.) Anoka County project coordinates by static GPS methods.

December 6, 2013 - Found cast iron monument and updated ties.

May 9, 2019 - Found cast iron monument below water level 0.3'±. Verified position by VRS GPS methods. Updated ties.

January 4, 2022 - Found cast iron monument flush. Verified position by VRS GPS methods. Updated ties.