

CERTIFICATE OF LOCATION OF GOVERNMENT CORNER

County of Anoka

State of Minnesota

Southeast Corner of Sec. 9 Township 33 Range 22

On the 30th day of November, 1955, the described corner was evidenced by a 4" X 6" concrete monument found by E.A. Westman

and to perpetuate the location of said corner, at the exact location thereof, a permanent marker was placed consisting of the same concrete monument with a 1/2" iron pipe on the west edge

AND on the 12th day of April, 2022, said permanent marker was found down 0.2'± and the ties were updated

Updated reference ties are as shown below.

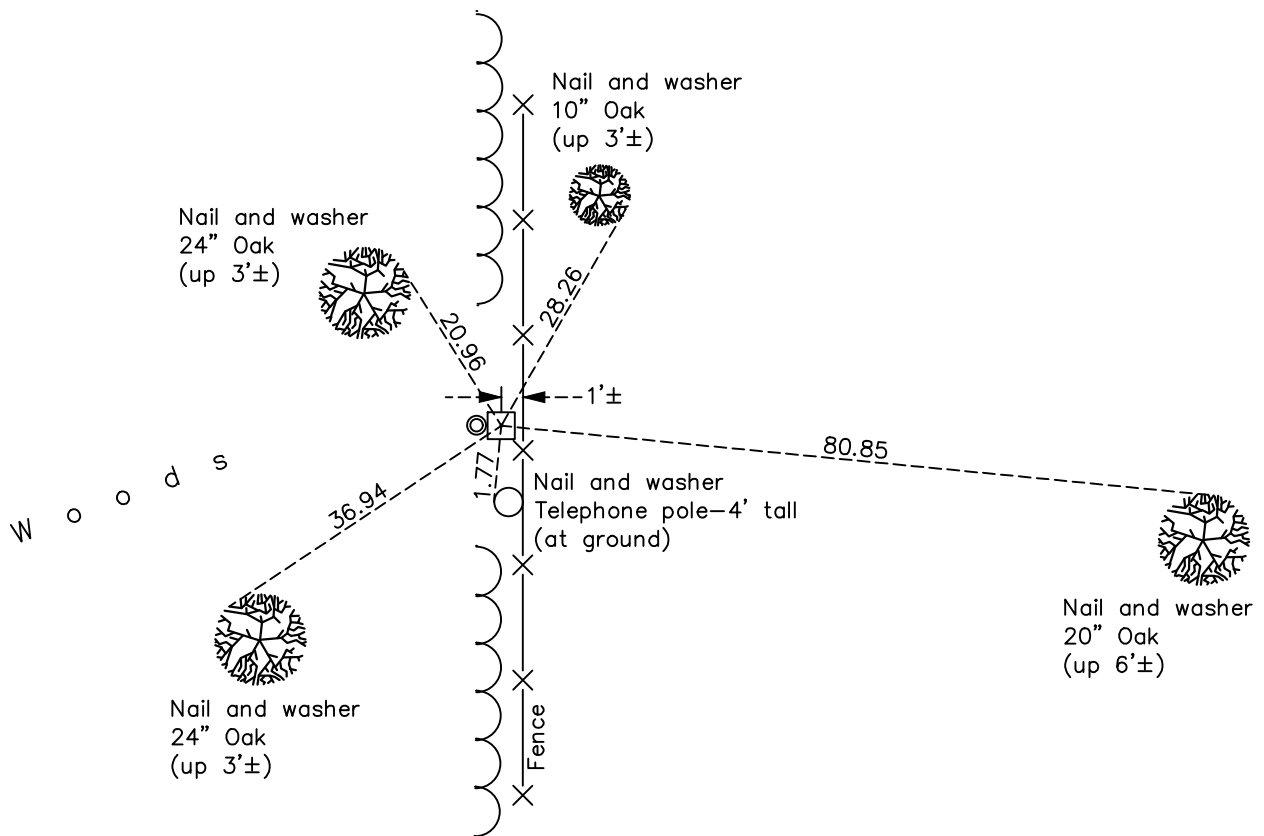

Revision Date

4/19/2022

N.A.D. 1983 Coordinates
(1996 Adjustment)

County Project Coordinates	
Northing	<u>216712.3166</u>
Easting	<u>547472.1215</u>
Date	<u>5/06/04</u>

I hereby certify that this United States public land survey monument record is correct and complete to the best of my knowledge and belief.

David Zieglmeier Date 12/11/23

David Zieglmeier Anoka County Surveyor
Minnesota License Number 46179

HISTORY OF GOVERNMENT CORNER

Page No. 53

County of Anoka

State of Minnesota

Southeast Corner of Sec. 9 Township 33 Range 22

CORNER HISTORY:

November 30, 1955 - Found 4" x 5" concrete monument and established ties to monument by E. A. Westman.

August 31, 1964 - Found 4" x 6" concrete monument flush and updated ties. Placed 1/2" iron pipe on west face of monument flush.

June 28, 1967 - Found concrete monument and updated ties.

July 24, 1975 - Found concrete monument and updated ties.

August 7, 1978 - Found concrete monument and updated ties.

August 25, 1981 - Found concrete monument and updated ties.

December 24, 1990 - Found concrete monument and updated ties.

July 13, 1993 - Found concrete monument and updated ties.

May 6, 2004 - Established NAD 1983 (1996 adj.) Anoka County project coordinates by static GPS methods.

December 20, 2013 - Found concrete monument and updated ties.

June 5, 2019 - Found concrete monument down 0.2'± and updated ties.

April 12, 2022 - Found concrete monument down 0.2'± and verified position by VRS GPS method. Updated ties.