

CERTIFICATE OF LOCATION OF GOVERNMENT CORNER

County of Anoka

State of Minnesota

South $\frac{1}{4}$ Corner of Sec. 13 Township 33 Range 22

On the 15th day of October, 1968, the described corner was evidenced by a granite monument found using Hult ties

and to perpetuate the location of said corner, at the exact location thereof, a permanent marker was placed consisting of the same granite monument with an iron pipe set on the north side

AND on the 3rd day of April, 2023, said permanent marker was found down 1'± and verified position correct with published coordinates and compared updated ties to historical ties.

Updated reference ties are as shown below.

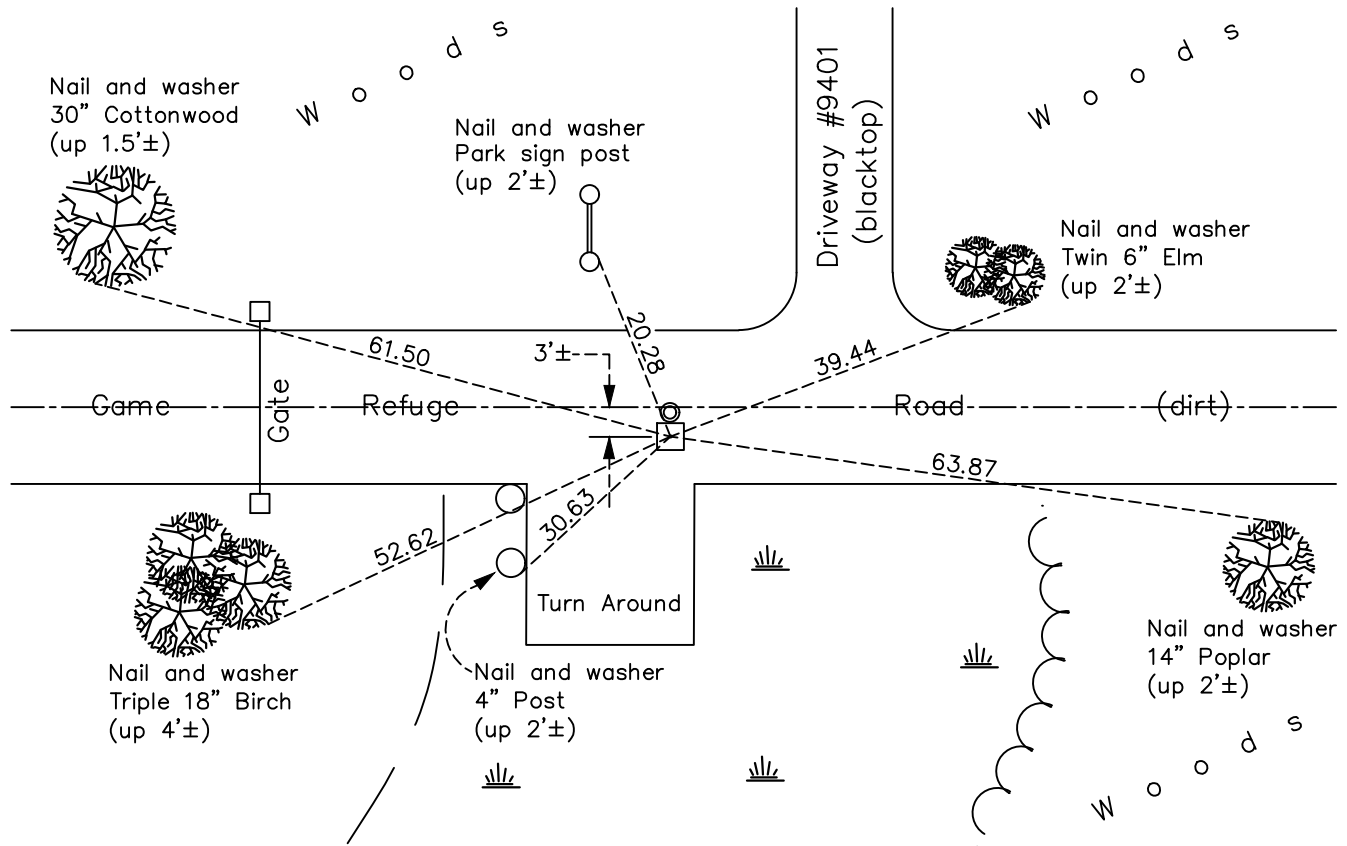

N.A.D. 1983 Coordinates
(1996 Adjustment)

County Project Coordinates	
Northing	<u>211289.9112</u>
Easting	<u>560845.6110</u>
Date	<u>5/05/04</u>

Revision Date
4/07/2022

I hereby certify that this United States public land survey monument record is correct and complete to the best of my knowledge and belief.
David Zieglmeier Date 4/13/23
 David Zieglmeier Anoka County Surveyor
 Minnesota License Number 46179

HISTORY OF GOVERNMENT CORNER

Page No. 70

County of Anoka

State of Minnesota

South 1/4 Corner of Sec. 13 Township 33 Range 22

CORNER HISTORY:

October 15, 1968 - Found granite monument down 1'± using ties by Don Hult. Updated ties.

June 2, 1971 - Found granite monument down 0.8'± and updated ties.

July 25, 1975 - Found granite monument and updated ties.

July 25, 1978 - Found granite monument and updated ties.

August 5, 1981 - Found granite monument and updated ties.

October 22, 1990 - Found granite monument and updated ties.

July 9, 1993 - Found granite monument and updated ties.

May 5, 2004 - Established NAD 1983 (1996 adj.) Anoka County project coordinates by static GPS methods.

April 8, 2014 - Found granite monument down 1'±. Verified position by VRS GPS methods. Updated ties.

April 4, 2019 - Found granite monument down 1'±. Verified position by VRS GPS methods. Updated ties.

March 23, 2022 - Found granite monument down 1'±. Verified position by VRS GPS methods. Updated ties.

April 3, 2023 - Found granite monument down 1'±. Verified position correct with published coordinates using ACS RTK GPS method and compared updated ties to historical ties.