

CERTIFICATE OF LOCATION OF GOVERNMENT CORNER

County of Anoka

State of Minnesota

North 1/4 Corner of Sec. 26 Township 34 Range 22

On the 20th day of June, 1966, the described corner was evidenced by a cast iron monument set by N.C. Hoium in place of a concrete monument

and to perpetuate the location of said corner, at the exact location thereof, a permanent marker was placed consisting of Isanti County cast iron monument with a sign and post on the north side

AND on the 7th day of December, 2021, said permanent marker was found down 0.1'± and the ties were updated

Updated reference ties are as shown below.

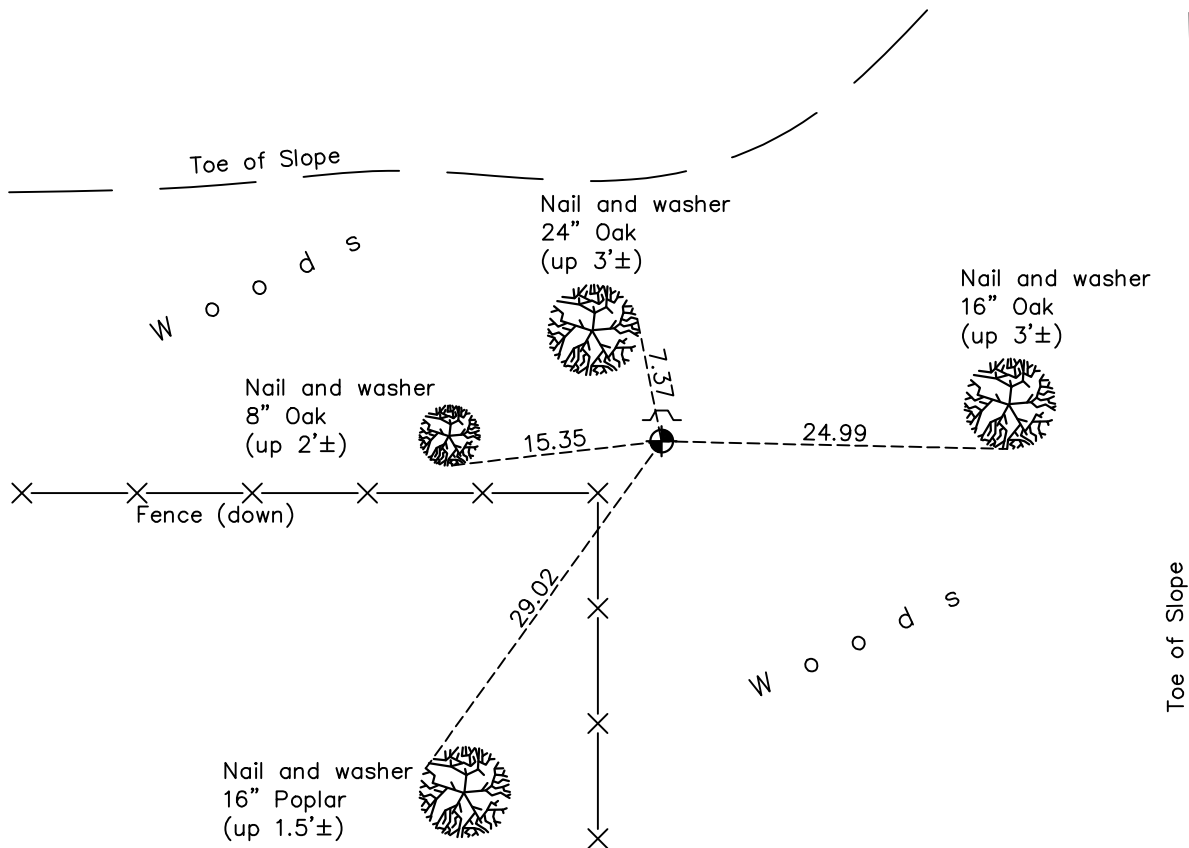

Revision Date

01/26/2022

N.A.D. 1983 Coordinates
(1996 Adjustment)

County Project Coordinates	
Northing	<u>237541.5829</u>
Easting	<u>555560.3500</u>
Date	<u>1/20/04</u>

I hereby certify that this United States public land survey monument record is correct and complete to the best of my knowledge and belief.

David Zieglmeier Date 3/22/24

David Zieglmeier Anoka County Surveyor
Minnesota License Number 46179

HISTORY OF GOVERNMENT CORNER

Page No. 5

County of Anoka

State of Minnesota

North 1/4 Corner of Sec. 26 Township 34 Range 22

CORNER HISTORY:

June 20, 1966 - N.C. Hoium found concrete monument and replaced with a cast iron monument. Updated ties.

August 19, 1966 - Found cast iron monument and updated ties.

June 20, 1967 - Found cast iron monument and updated ties.

July 7, 1971 - Found cast iron monument and updated ties.

August 1, 1975 - Found cast iron monument and updated ties.

August 8, 1978 - Found cast iron monument and updated ties.

June 15, 1982 - Found cast iron monument and updated ties.

August 14, 1986 - Found cast iron monument and updated ties.

July 1, 1993 - Found cast iron monument and updated ties.

January 20, 2004 - Established NAD 1983 (1996 adj.) Anoka County project coordinates by static GPS methods.

February 4, 2014 - Found cast iron monument and updated ties.

December 28, 2018 - Found cast iron monument down 0.1'± and updated ties.

December 7th, 2021 - Found cast iron monument down 0.1'±, verified position by VRS GPS method and updated ties.