

CERTIFICATE OF LOCATION OF GOVERNMENT CORNER

County of Anoka

State of Minnesota

Northwest Corner of Sec. 29 Township 34 Range 22

On the 1st day of February, 1979, the described corner was evidenced by area resurvey

and to perpetuate the location of said corner, at the exact location thereof, a permanent marker was placed consisting of a cast iron monument

AND on the 31st day of March, 2023, said permanent marker was found leaning and removed.
Replaced with 2" x 6" Telspar set to Published Coordinates, up 0.5'±. Updated ties after replacement.

Updated reference ties are as shown below.

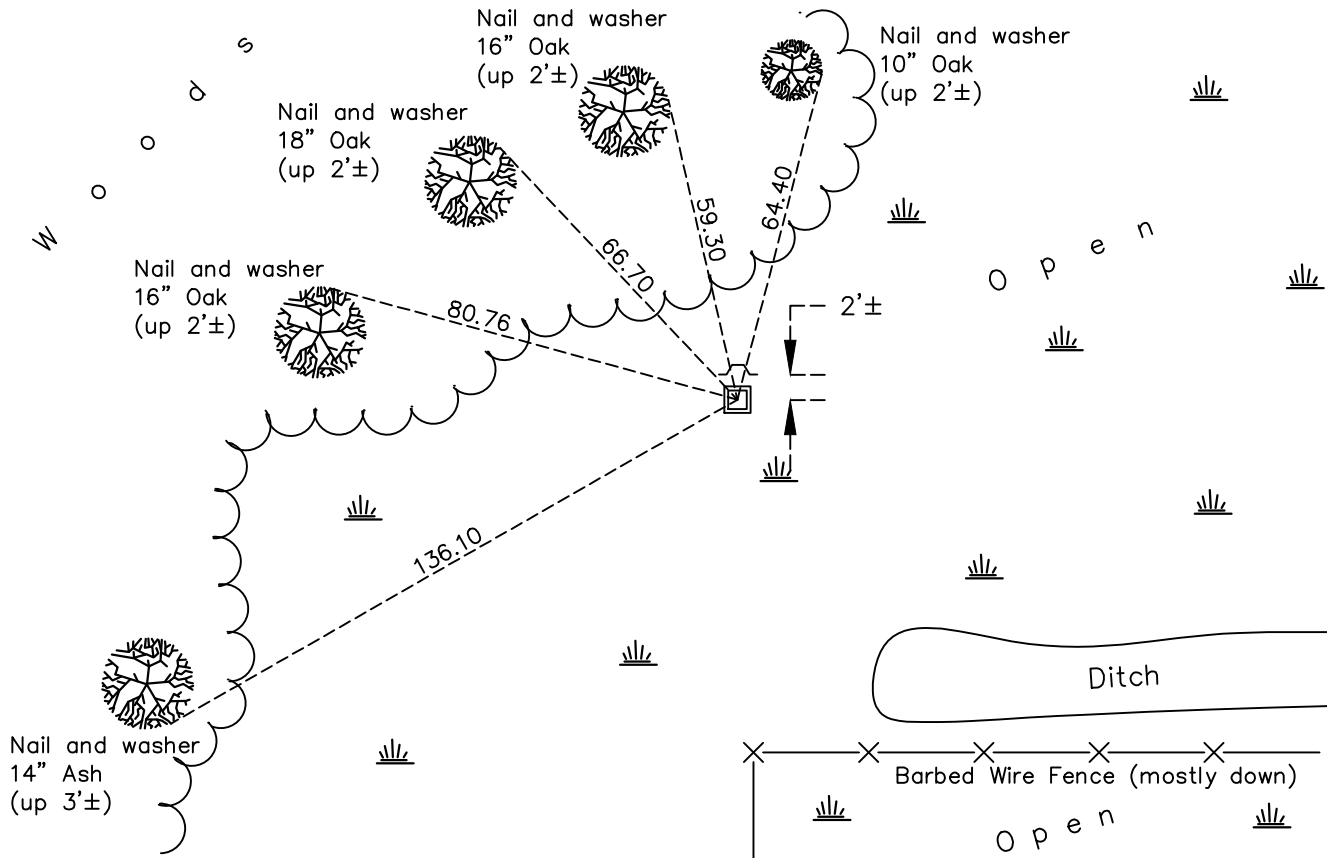

Revision Date

4/07/2023

N.A.D. 1983 Coordinates
(1996 Adjustment)

County Project Coordinates	
Northing	<u>238028.8283</u>
Easting	<u>536945.8900</u>
Date	<u>4/27/04</u>

I hereby certify that this United States public land survey monument record is correct and complete to the best of my knowledge and belief.

David Zieglmeier Date 4/13/23

David M. Zieglmeier, Anoka County Surveyor
Minnesota License Number 46179

HISTORY OF GOVERNMENT CORNER

Page No. 13

County of Anoka

State of Minnesota

Northwest Corner of Sec. 29 Township 34 Range 22

CORNER HISTORY:

February 1, 1979 - Set 1/2" iron pipe using area resurvey and established ties to iron pipe.

April 30, 1979 - Found 1/2" iron pipe and replaced with a cast iron monument. Updated ties to monument.

June 9, 1982 - Found cast iron monument and updated ties.

August 13, 1986 - Found cast iron monument and updated ties.

January 21, 1988 - Found cast iron monument flush and updated ties.

July 7, 1993 - Found cast iron monument and updated ties.

April 27, 2004 - Established NAD 1983 (1996 adj.) Anoka County project coordinates by static GPS methods.

May 6, 2014 - Found cast iron monument up 0.5'± and leaning southerly. Verified position by VRS GPS methods and updated ties.

February 15, 2022 - Found cast iron monument up 0.5'± and leaning southerly. Verified position by VRS GPS methods and updated ties.

March 31, 2023 - Found and removed Southern'ly leaning cast iron monument. Replaced with 2" square steel Telspar and cap w/ punch mark to depth of 7'± left up 0.5'±, set using ACS RTK GPS method to published coordinates. Updated ties after replacement verifying position to Historical Ties.