

CERTIFICATE OF LOCATION OF GOVERNMENT CORNER

County of Anoka

State of Minnesota

Southwest Corner of Sec. 26 Township 34 Range 22

On the 4th day of February, 1963, the described corner was evidenced by a cast iron monument

and to perpetuate the location of said corner, at the exact location thereof, a permanent marker was placed consisting of the same cast iron monument with a sign and post on the north side

AND on the 31st day of March, 2022, said permanent marker was found up 0.2'± and the ties were updated

Updated reference ties are as shown below.

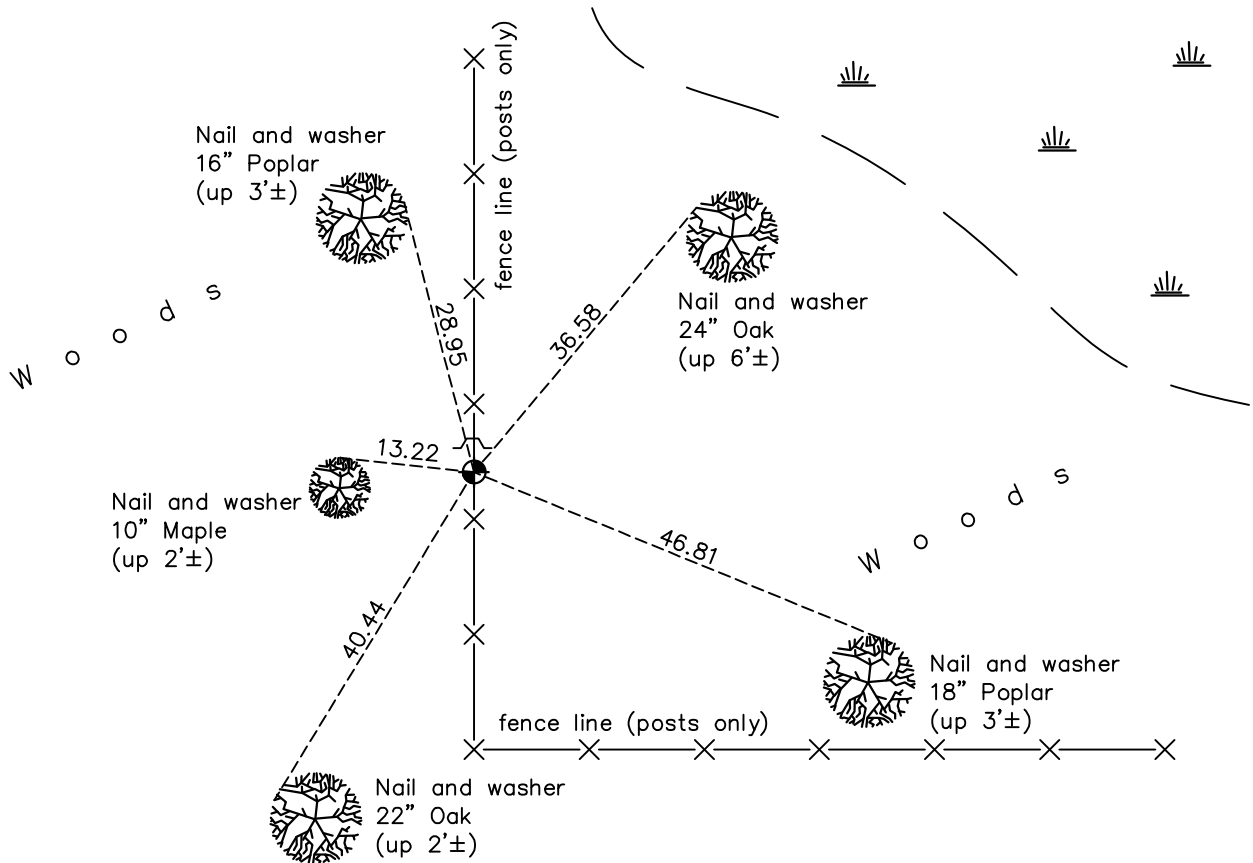

Revision Date

4/07/2022

N.A.D. 1983 Coordinates
(1996 Adjustment)

County Project Coordinates	
Northing	<u>232318.4636</u>
Easting	<u>553062.7411</u>
Date	<u>1/26/04</u>

I hereby certify that this United States public land survey monument record is correct and complete to the best of my knowledge and belief.

David Zieglmeier Date 3/25/24

David Zieglmeier Anoka County Surveyor
Minnesota License Number 46179

HISTORY OF GOVERNMENT CORNER

Page No. 26

County of Anoka

State of Minnesota

Southwest Corner of Sec. 26 Township 34 Range 22

CORNER HISTORY:

February 4, 1963 - Found cast iron monument set by N.C. Hoium and established ties to monument.

June 21, 1967 - Found cast iron monument and updated ties.

July 8, 1971 - Found cast iron monument and updated ties.

January 13, 1978 - Found cast iron monument and updated ties.

January 26, 2004 - Established NAD 1983 (1996 adj.) Anoka County project coordinates by static GPS methods.

February 12, 2014 - Found cast iron monument up 0.2'± and updated ties.

June 5, 2019 - Found cast iron monument up 0.2'± and updated ties.

March 31, 2022 - Found cast iron monument up 0.2'± and verified position by VRS GPS method. Ties updated.