

# CERTIFICATE OF LOCATION OF GOVERNMENT CORNER

County of Anoka

State of Minnesota

## West 1/4 Corner of Sec. 35 Township 34 Range 22

On the 13th day of November, 1975, the described corner was evidenced by area resurvey

and to perpetuate the location of said corner, at the exact location thereof, a permanent marker was placed consisting of a cast iron monument with a sign and post on the north side 1.5'±  
from mon.

AND on the 15th day of December, 2021, said permanent marker was found down 0.1'± and  
the ties were updated

Updated reference ties are as shown below.

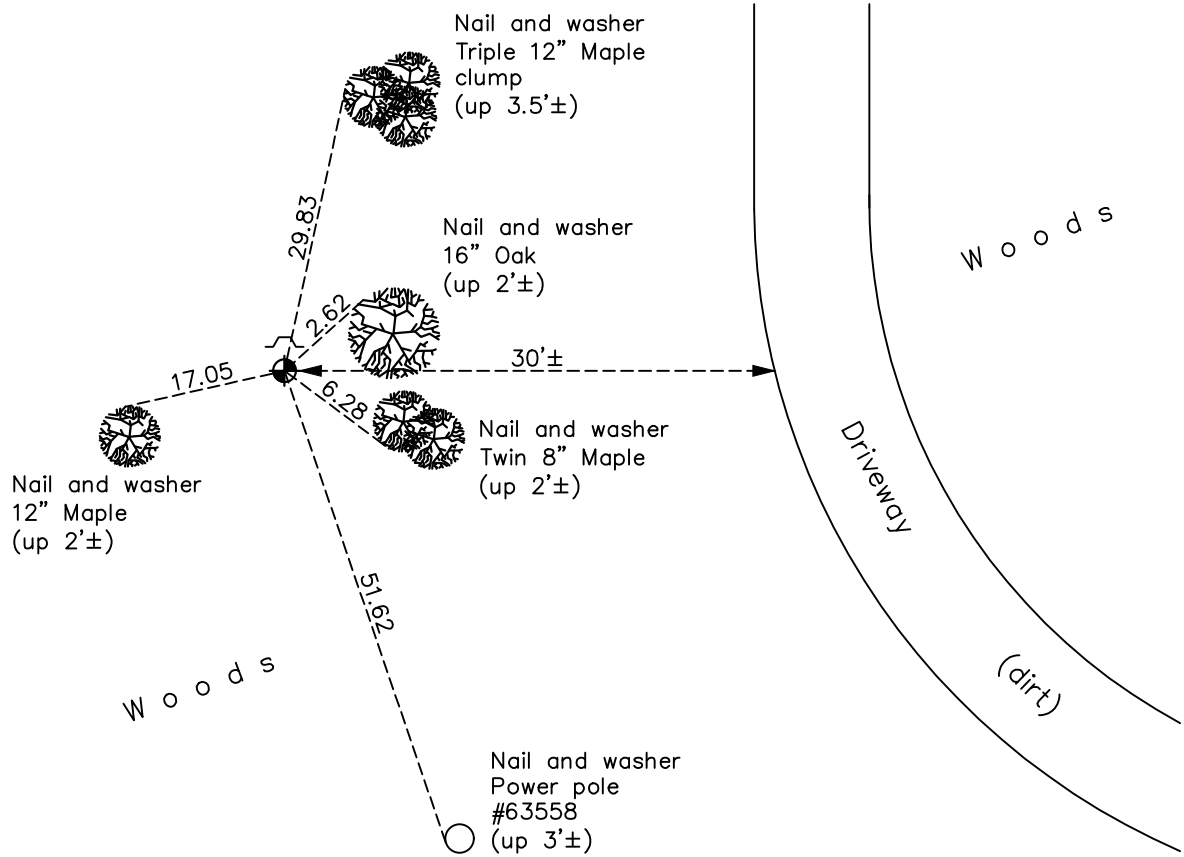

Revision Date  
03/15/22

N.A.D. 1983 Coordinates  
 (1996 Adjustment)

County Project Coordinates	
Northing	<u>229681.5000</u>
Easting	<u>553176.9174</u>
Date	<u>2/04/04</u>

I hereby certify that this United States public land survey monument record is correct and complete to the best of my knowledge and belief.

*David Zieglermeier* Date 3/25/24

David M. Zieglermeier, Anoka County Surveyor  
 Minnesota License Number 46179

# HISTORY OF GOVERNMENT CORNER

Page No. 38

County of Anoka

State of Minnesota

West 1/4 Corner of Sec. 35 Township 34 Range 22

## **CORNER HISTORY:**

November 13, 1975 - Set cast iron monument using area resurvey and established ties to monument.

August 14, 1978 - Found cast iron monument and updated ties.

June 9, 1982 - Found cast iron monument and updated ties.

July 5, 1993 - Found cast iron monument and updated ties.

February 4, 2004 - Established NAD 1983 (1996 adj.) Anoka County project coordinates by static GPS methods.

February 3, 2014 - Found cast iron monument and updated ties.

January 22, 2019 - Found cast iron monument and updated ties.

December 15, 2021 - Found cast iron monument down 0.1'± Verified position by VRS GPS methods, and updated ties.