

CERTIFICATE OF LOCATION OF GOVERNMENT CORNER

County of Anoka

State of Minnesota

North $\frac{1}{4}$ Corner of Sec. 6 Township 33 Range 25

On the 22nd day of April, 1963, the described corner was evidenced by area resurvey

and to perpetuate the location of said corner, at the exact location thereof, a permanent marker was placed consisting of a cast iron monument with a "T" post on the north side of monument

AND on the 19th day of January, 2018, said permanent marker was found flush with the surface leaning slightly northeasterly. The ties were updated

Updated reference ties are as shown below.

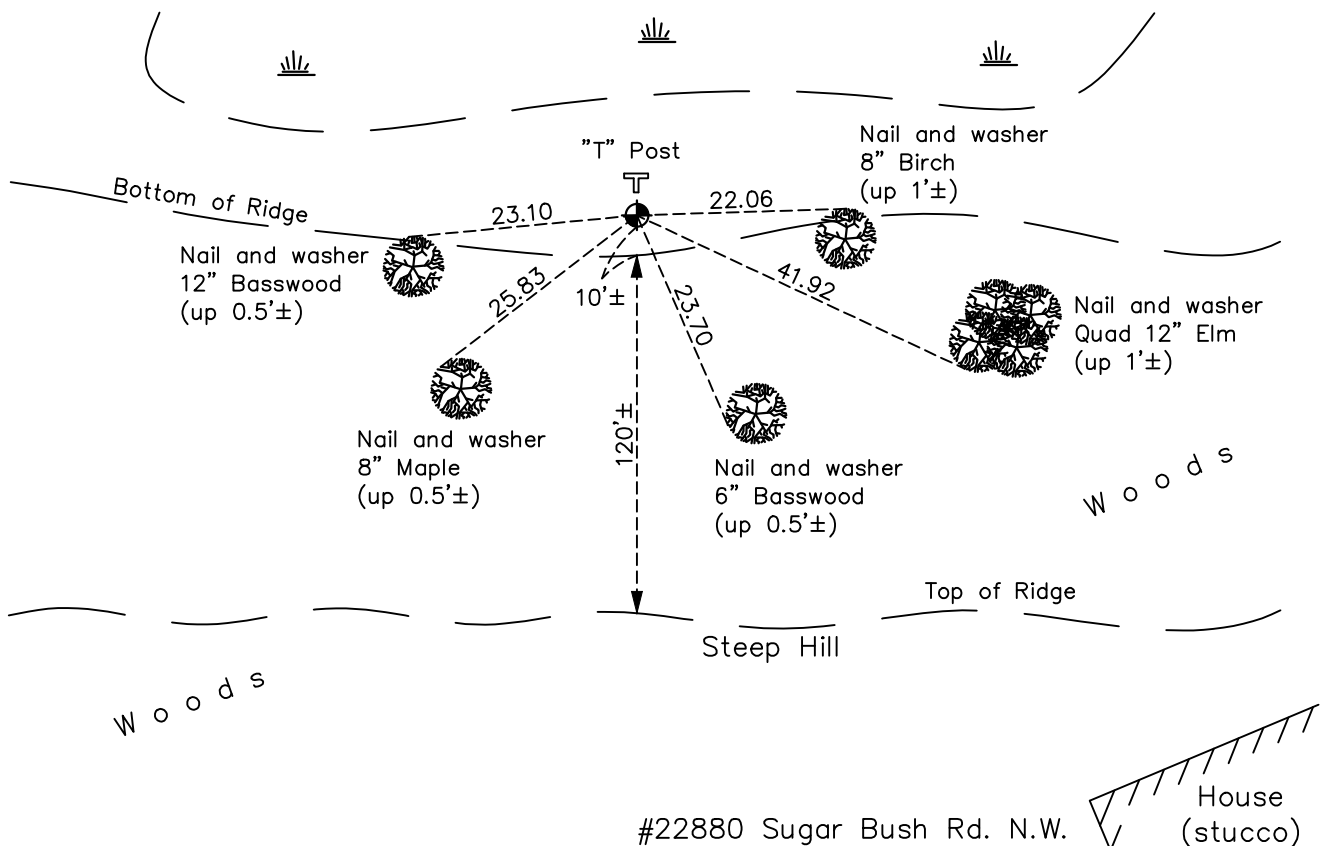

N

S

W E

ANOKA COUNTY SURVEYOR

Revision Date

4/12/18

N.A.D. 1983 Coordinates
(1996 Adjustment)

County Project Coordinates	
Northing	<u>227817.2349</u>
Easting	<u>439663.0217</u>
Date	<u>2/06/03</u>

I hereby certify that this United States public land survey monument record is correct and complete to the best of my knowledge and belief.

David Zieglsmeier Date 6/8/21

David M. Zieglsmeier, Anoka County Surveyor

Minnesota License Number 46179

#22880 Sugar Bush Rd. N.W.

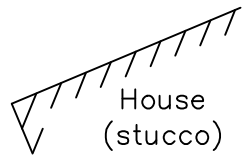

HISTORY OF GOVERNMENT CORNER

Page No. 12

County of Anoka

State of Minnesota

North 1/4 Corner of Sec. 6 Township 33 Range 25

CORNER HISTORY:

September 1849 - This corner was established by Theodore Conkey, Deputy Surveyor. Conkey marked the position by "set post for quarter section corner" with two bearing trees marked as accessories.

April 22, 1963 - Set cast iron monument up 0.1'± using area resurvey. Established ties to monument.

August 10, 1965 - Found cast iron monument and updated ties.

July 11, 1969 - Found cast iron monument and updated ties.

August 2, 1973 - Found cast iron monument and updated ties.

July 14, 1976 - Found cast iron monument and updated ties.

July 10, 1979 - Found cast iron monument and updated ties.

August 4, 1982 - Found cast iron monument and updated ties.

July 15, 1985 - Found cast iron monument and updated ties.

June 19, 1989 - Found cast iron monument and updated ties.

June 28, 1994 - Found cast iron monument and updated ties.

February 6, 2003 - Found cast iron monument and updated ties. Established NAD 1983 (1996 adj.) Anoka County project coordinates by static GPS methods.

April 15, 2013 - Found cast iron monument leaning slightly northeasterly with a "T" post on the north side. Updated ties.

January 19, 2018 - Found cast iron monument flush and leaning slightly northeasterly with a "T" post on the north side. Verified position by VRS GPS methods. Updated ties.