

CERTIFICATE OF LOCATION OF GOVERNMENT CORNER

County of Anoka

State of Minnesota

South 1/4 Corner of Sec. 4 Township 33 Range 25

On the 2nd day of December, 1974, the described corner was evidenced by area resurvey

and to perpetuate the location of said corner, at the exact location thereof, a permanent marker was placed consisting of a cast iron monument with a sign and post 1.25'± north of monument

AND on the 28th day of December, 2017, said permanent marker was found flush and the ties were updated

Updated reference ties are as shown below.

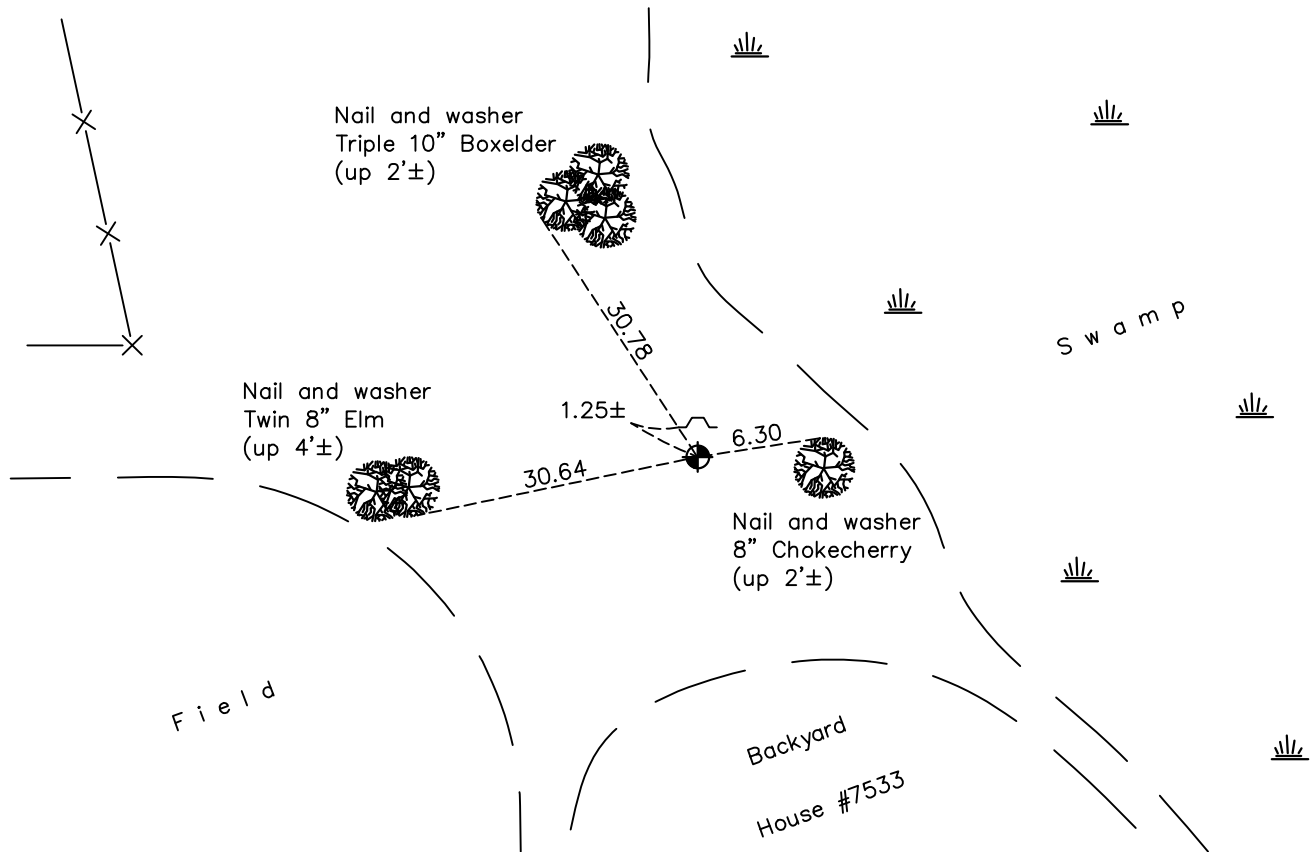

Revision Date

4/12/18

N.A.D. 1983 Coordinates
(1996 Adjustment)

County Project Coordinates	
Northing	<u>222576.0562</u>
Easting	<u>450257.0672</u>
Date	<u>12/07/02</u>

I hereby certify that this United States public land survey monument record is correct and complete to the best of my knowledge and belief.

David M Ziegler Date 6/9/21

David M. Ziegler, Anoka County Surveyor

Minnesota License Number 46179

HISTORY OF GOVERNMENT CORNER

Page No. 27

County of Anoka

State of Minnesota

South 1/4 Corner of Sec. 4 Township 33 Range 25

CORNER HISTORY:

May 1855 - This corner was established by James M. Marsh, Deputy Surveyor. Marsh marked the position by "set quarter section post" with two bearing trees marked as accessories.

December 2, 1974 - Set cast iron monument using area resurvey. Established ties to monument. Set sign and post on north side.

July 16, 1976 - Found cast iron monument and updated ties.

July 17, 1979 - Found cast iron monument and updated ties.

August 4, 1982 - Found cast iron monument and updated ties.

June 14, 1989 - Found cast iron monument and updated ties.

July 5, 1994 - Found cast iron monument and updated ties.

July 29, 2002 - Found cast iron monument and updated ties.

December 7, 2002 - Established NAD 1983 (1996 adj.) Anoka County project coordinates by static GPS methods.

March 26, 2013 - Found cast iron monument flush w/sign and post 1.25'± north of monument. Verified position by VRS GPS methods. Updated ties.

December 28, 2017 - Found cast iron monument flush and updated ties.