

CERTIFICATE OF LOCATION OF GOVERNMENT CORNER

County of Anoka

State of Minnesota

West 1/4 Corner of Sec. 12 Township 33 Range 25

On the 24th day of May, 1974, the described corner was evidenced by area resurvey

and to perpetuate the location of said corner, at the exact location thereof, a permanent marker was placed consisting of a red and white iron pipe up 2'±

AND on the 22nd day of January, 2018, said permanent marker was found leaning slightly and the ties were updated

Updated reference ties are as shown below.

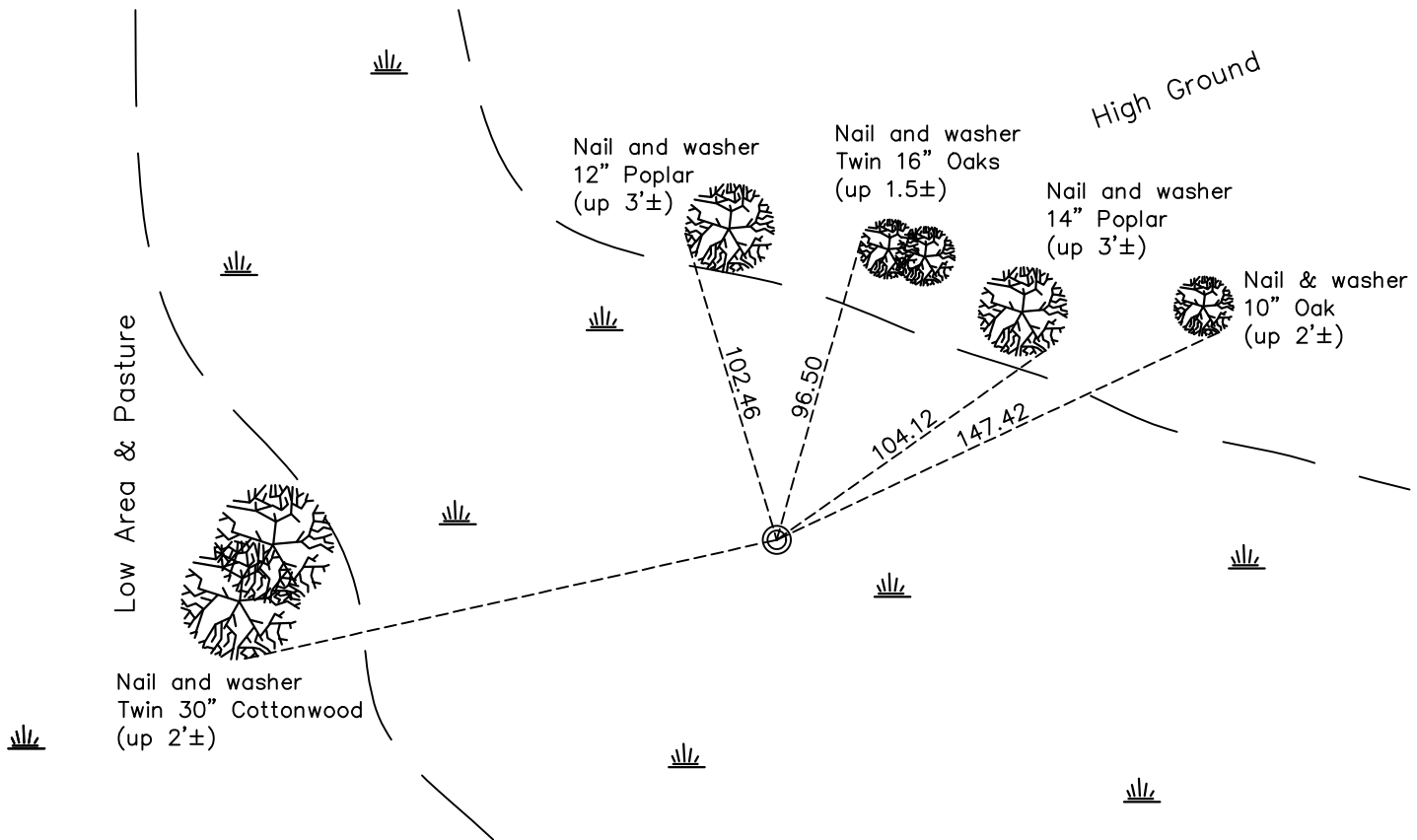

Revision Date

4/13/18

N.A.D. 1983 Coordinates
(1996 Adjustment)

County Project Coordinates	
Northing	219753.2586
Easting	463391.3998
Date	11/27/02

I hereby certify that this United States public land survey monument record is correct and complete to the best of my knowledge and belief.

David M. Zieglermeier Date 6/9/21

David M. Zieglermeier, Anoka County Surveyor

Minnesota License Number 46179

HISTORY OF GOVERNMENT CORNER

Page No. 38

County of Anoka

State of Minnesota

West 1/4 Corner of Sec. 12 Township 33 Range 25

CORNER HISTORY:

May 1855 - This corner was established by James M. Marsh, Deputy Surveyor. Marsh marked the position by "set quarter section post" with two bearing trees marked as accessories.

May 24, 1974 - Set red and white iron pipe up 2'± using area resurvey. Established ties to iron pipe.

February 13, 1978 - Found red and white iron pipe and updated ties.

July 15, 1985 - Found red and white iron pipe and updated ties.

July 5, 1989 - Found red and white iron pipe and updated ties.

July 14, 1994 - Found red and white iron pipe and updated ties.

November 27, 2002 - Found red and white iron pipe and updated ties.

September 4, 2014 - Found red and white iron pipe up 2'±. Verified position by VRS GPS methods.

January 22, 2018 - Found red and white iron pipe up 2'± and slightly leaning. Updated ties.