

# CERTIFICATE OF LOCATION OF GOVERNMENT CORNER

County of Anoka

State of Minnesota

## Southwest Corner of Sec. 12 Township 33 Range 25

On the 8th day of February, 2024, the described corner was evidenced by a red & white  
2" square Telspar

and to perpetuate the location of said corner, at the exact location thereof, a permanent marker was placed consisting of same 2"x 2"x 8' Telspar adding aluminum cap and punch mark, correcting  
leaning position and adjusting from being up 6'± to 1'±.

AND on the 8th day of February, 2024, said permanent marker was measured with RTK GPS  
method to verify position and the ties were updated after setting.

Updated reference ties are as shown below.

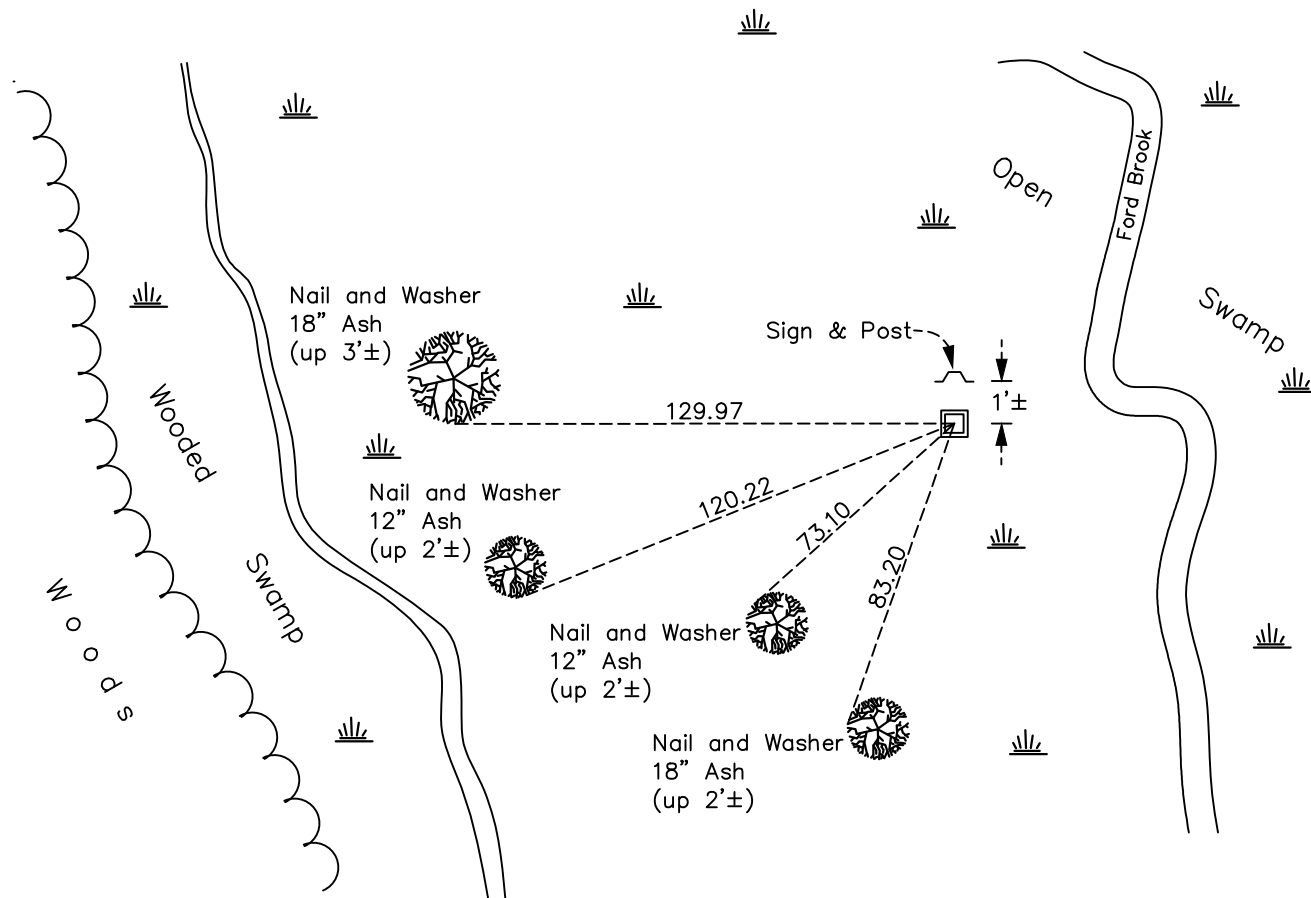

N.A.D. 1983 Coordinates  
(1996 Adjustment)

County Project Coordinates	
Northing	<u>217126.4680</u>
Easting	<u>463382.9770</u>
Date	<u>12/10/02</u>

Revision Date  
3/27/2024

I hereby certify that this United States public land survey monument record is correct and complete to the best of my knowledge and belief.

*David Zieglmeier* Date 3/28/24

David M. Zieglmeier, Anoka County Surveyor  
Minnesota License Number 46179

# HISTORY OF GOVERNMENT CORNER

Page No. 41

County of Anoka

State of Minnesota

12 Corner of Sec. 12 Township 33 Range 25

## **CORNER HISTORY:**

May 1855 - This corner was established by James M. Marsh, Deputy Surveyor. Marsh marked the position by "set post corner of sections 11, 12, 13 and 14" with two bearing trees marked as accessories.

February 1, 1966 - Found 1-1/2" iron pipe up 1'± set by Harvey A. Cartwright. Established ties to iron pipe.

December 23, 1973 - Found iron pipe and updated ties.

February 13, 1978 - Found iron pipe leaning south and updated ties.

January 13, 1982 - Iron pipe not found. Set red and white iron pipe up 3'± w/sign attached using two remaining corner ties. Updated ties.

July 11, 1985 - Found red and white iron pipe and updated ties.

September 19, 2002 - Found red and white Telspar monument and updated ties.

December 10, 2002 - Established NAD 1983 (1996 adj.) Anoka County project coordinates by static GPS methods.

January 23, 2018 - Found a red and white Telspar up 4.5'± w/sign attached and leaning slightly south. Verified position by VRS GPS methods. Updated ties.

July 21, 2021 - Found red and white Telspar up 6'± w/sign attached. Verified position by VRS GPS methods. Updated ties.

February 8, 2024 - Found red and white 2" square Telspar up 6'± and leaning. Adjusted same Telspar, adding 'County Surveyor' cap and punch mark, straightening, set up 1.0'±. Set to published coordinates using RTK GPS method and historic ties. Updated ties after setting. Added sign & post to north side. Job #24-100