

CERTIFICATE OF LOCATION OF GOVERNMENT CORNER

County of Anoka

State of Minnesota

Northeast Corner of Sec. 22 Township 33 Range 25

On the 18th day of July, 1969, the described corner was evidenced by ties from
N.C. Hoium

and to perpetuate the location of said corner, at the exact location thereof, a permanent marker was placed consisting of a cast iron monument with a "T" post on the west side

AND on the 23rd day of January, 2018, said permanent marker was found down 0.3'± and
the ties were updated

Updated reference ties are as shown below.

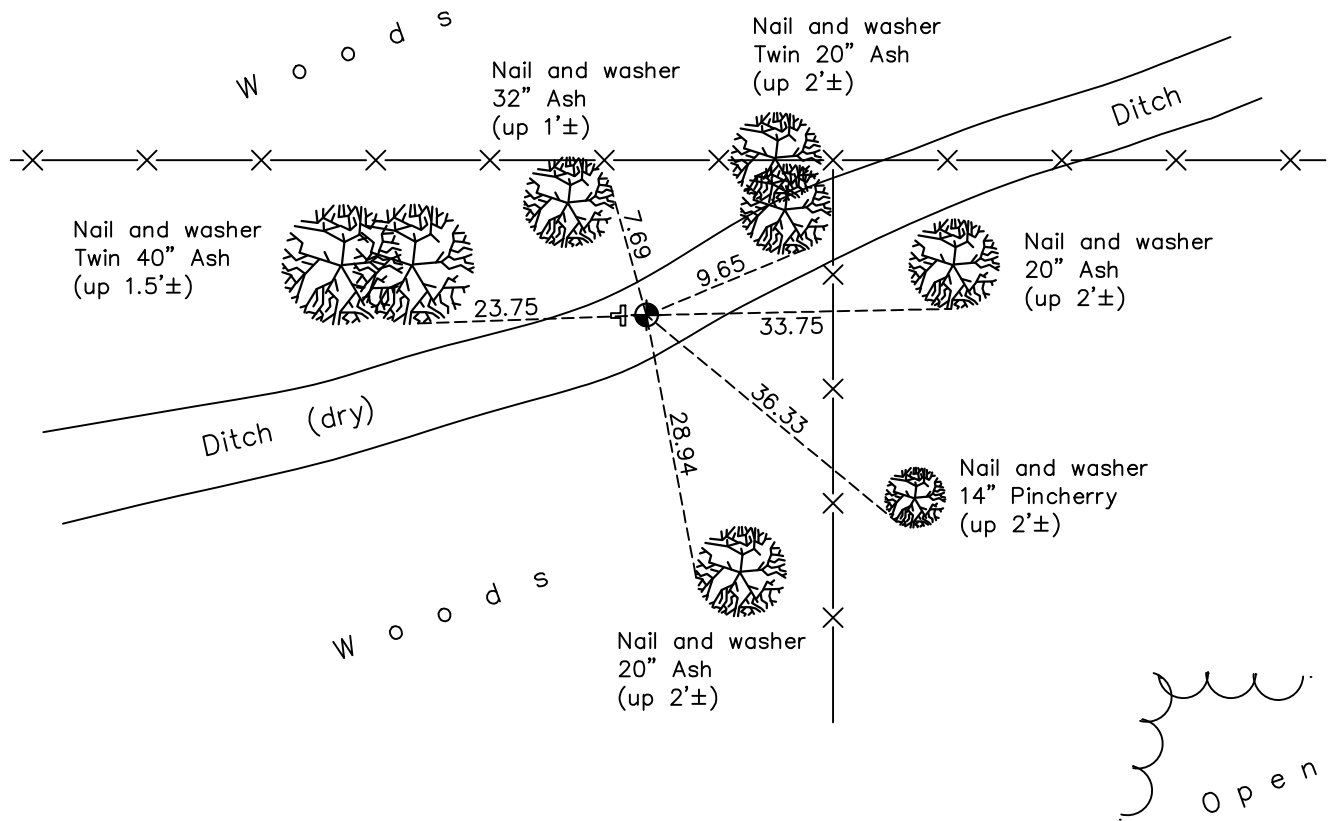

Revision Date

4/18/18

N.A.D. 1983 Coordinates
(1996 Adjustment)

County Project Coordinates	
Northing	<u>211965.9968</u>
Easting	<u>458133.0457</u>
Date	<u>2/13/03</u>

I hereby certify that this United States public land survey monument record is correct and complete to the best of my knowledge and belief.

David M. Zieglmeier Date 6/9/21

David M. Zieglmeier, Anoka County Surveyor

Minnesota License Number 46179

HISTORY OF GOVERNMENT CORNER

Page No. 62

County of Anoka

State of Minnesota

Northeast Corner of Sec. 22 Township 33 Range 25

CORNER HISTORY:

May 1855 - This corner was established by James M. Marsh, Deputy Surveyor. Marsh marked the position by "set post corner of sections 14, 15, 22 and 23" with two bearing trees marked as accessories.

1965 - N.C. Hoium found an iron pipe and updated ties.

July 18, 1969 - Iron pipe not found. Set cast iron monument up 0.1'± using Hoium's corner ties. Updated ties.

August 8, 1973 - Found cast iron monument and updated ties.

July 23, 1976 - Found cast iron monument and updated ties.

July 10, 1979 - Found cast iron monument and updated ties.

August 5, 1982 - Found cast iron monument and updated ties.

July 11, 1985- Found cast iron monument and updated ties.

June 28, 1989 - Found cast iron monument and updated ties.

July 15, 1994 - Found cast iron monument and updated ties.

February 13, 2003 - Established NAD 1983 (1996 adj.) Anoka County project coordinates by static GPS methods.

February 13, 2004 - Found cast iron monument and updated ties.

October 22, 2013 - Found cast iron monument with a "T" post on west side. Updated ties.

January 23, 2018 - Found cast iron monument down 0.3'±. Updated ties.