

CERTIFICATE OF LOCATION OF GOVERNMENT CORNER

County of Anoka

State of Minnesota

South 1/4 Corner of Sec. 17 Township 33 Range 25

On the 31st day of July, 1973, the described corner was evidenced by a corner set by N.C. Hoium

and to perpetuate the location of said corner, at the exact location thereof, a permanent marker was placed consisting of a red and white iron pipe

AND on the 1st day of December, 2014, said permanent marker was found up 1'± with a sign attached facing south and the ties were updated

Updated reference ties are as shown below.

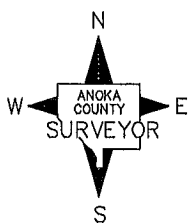
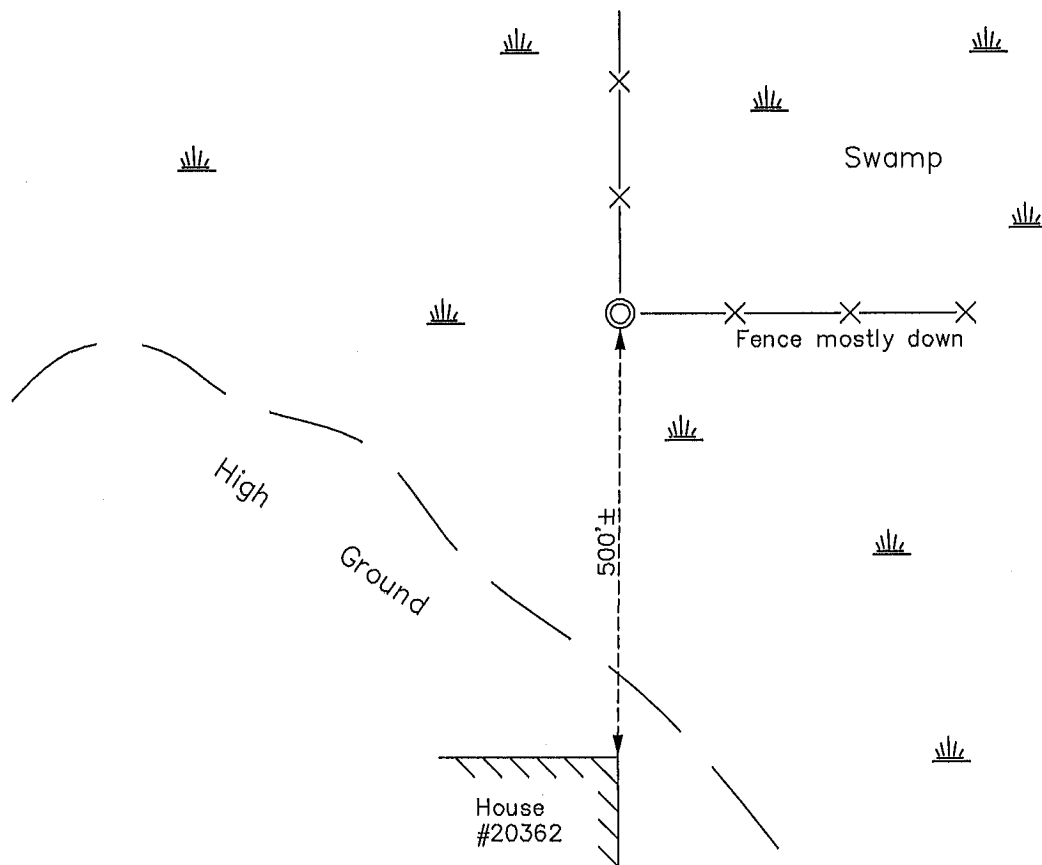

Revision Date
3/12/15

N.A.D. 1983 Coordinates
(1996 Adjustment)

County Project Coordinates	
Northing	<u>212102.7885</u>
Easting	<u>444951.9841</u>
Date	<u>2/11/03</u>

I hereby certify that this United States public land survey monument record is correct and complete to the best of my knowledge and belief.

Larry D. Hoium Date 3/12/15
 _____, Anoka County Surveyor
 Minnesota License Number 18165