

CERTIFICATE OF LOCATION OF GOVERNMENT CORNER

County of Anoka

State of Minnesota

East 1/4 Corner of Sec. 30 Township 33 Range 25

On the 15th day of October, 1963, the described corner was evidenced by a 1" axle shaft

and to perpetuate the location of said corner, at the exact location thereof, a permanent marker was placed consisting of a cast iron monument with a sign and post on the north side

AND on the 18th day of January, 2018, said permanent marker was found up 0.2'± and the ties were updated

Updated reference ties are as shown below.

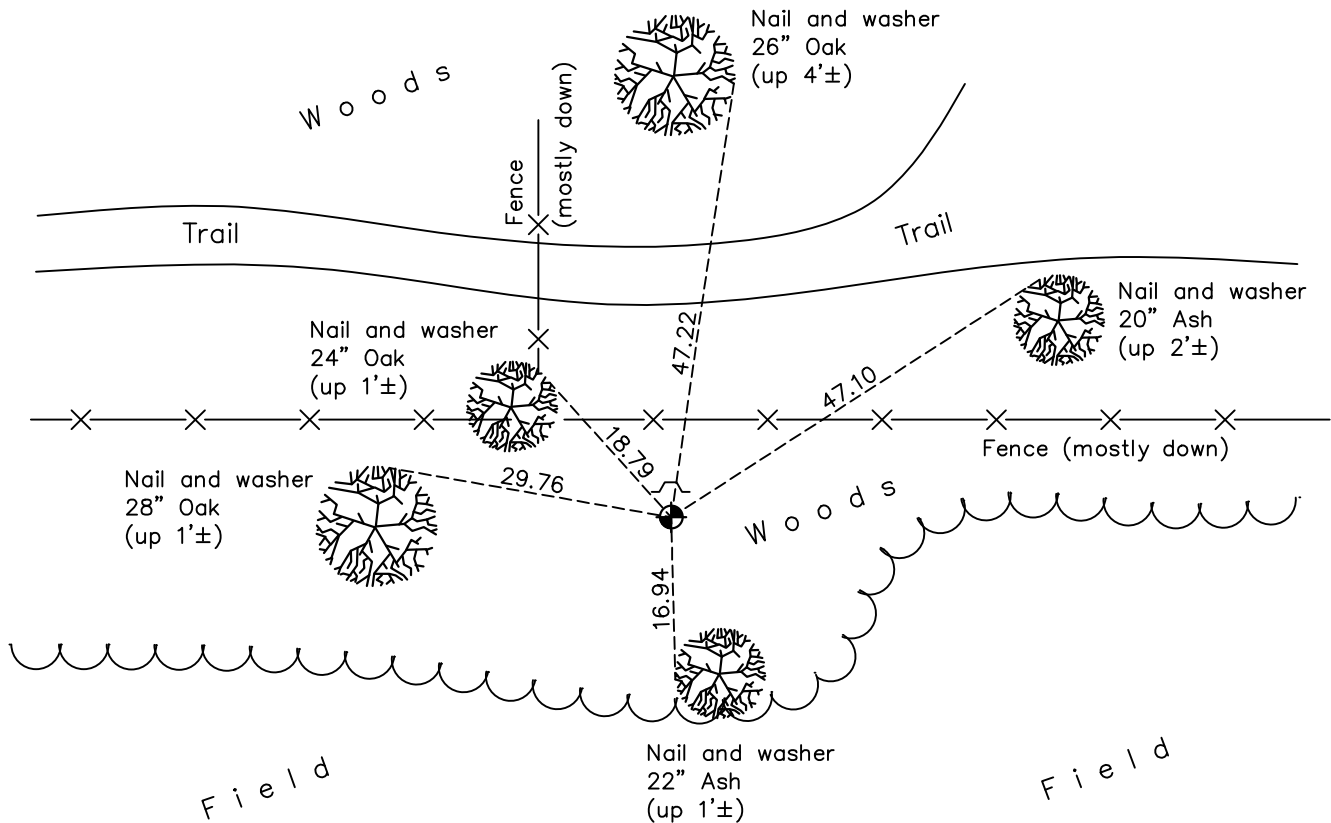

Revision Date

4/23/18

N.A.D. 1983 Coordinates
(1996 Adjustment)

County Project Coordinates	
Northing	<u>204258.0629</u>
Easting	<u>442449.2992</u>
Date	<u>2/18/03</u>

I hereby certify that this United States public land survey monument record is correct and complete to the best of my knowledge and belief.

David M Zieglmeier Date 6/9/21

David M. Zieglmeier, Anoka County Surveyor

Minnesota License Number 46179

HISTORY OF GOVERNMENT CORNER

Page No. 91

County of Anoka

State of Minnesota

East 1/4 Corner of Sec. 30 Township 33 Range 25

CORNER HISTORY:

May 1855 - This corner was established by James M. Marsh, Deputy Surveyor. Marsh marked the position by "set quarter section post" with two bearing trees marked as accessories.

November 9, 1946 - Harvey Cartwright set a concrete monument online between the northeast and southeast section corners at proportioned old surveyors distances. Established ties to monument.

October 15, 1963 - Found 1" axle shaft up 0.4'± in place of concrete monument per Cartwright ties. Updated ties.

August 25, 1965 - Replaced 1" axle shaft with a cast iron monument and updated ties.

July 10, 1969 - Found cast iron monument and updated ties.

August 6, 1973 - Found cast iron monument and updated ties.

July 28, 1976 - Found cast iron monument and updated ties.

July 23, 1979 - Found cast iron monument and updated ties.

August 10, 1982 - Found cast iron monument and updated ties.

July 12, 1985 - Found cast iron monument and updated ties.

June 12, 1989 - Found cast iron monument w/sign and post on the north side. Updated ties.

June 8, 1994 - Found cast iron monument w/sign and post on the north side. Updated ties.

February 18, 2003 - Established NAD 1983 (1996 adj.) Anoka County project coordinates by static GPS methods.

October 29, 2013 - Found cast iron monument up 0.2'± and updated ties.

January 18, 2018 - Found cast iron monument up 0.2'± and updated ties.