

CERTIFICATE OF LOCATION OF GOVERNMENT CORNER

County of Anoka

State of Minnesota

Southwest Corner of Sec. 25 Township 33 Range 25

On the 15th day of February, 2024, the described corner was evidenced by a granite monument

and to perpetuate the location of said corner, at the exact location thereof, a permanent marker was placed consisting of the same granite monument, correcting leaning position and adjusting to be up 0.6'±.

AND on the 15th day of February, 2024, said permanent marker was measured with RTK GPS method to verify position and ties were updated after adjusting.

Updated reference ties are as shown below.

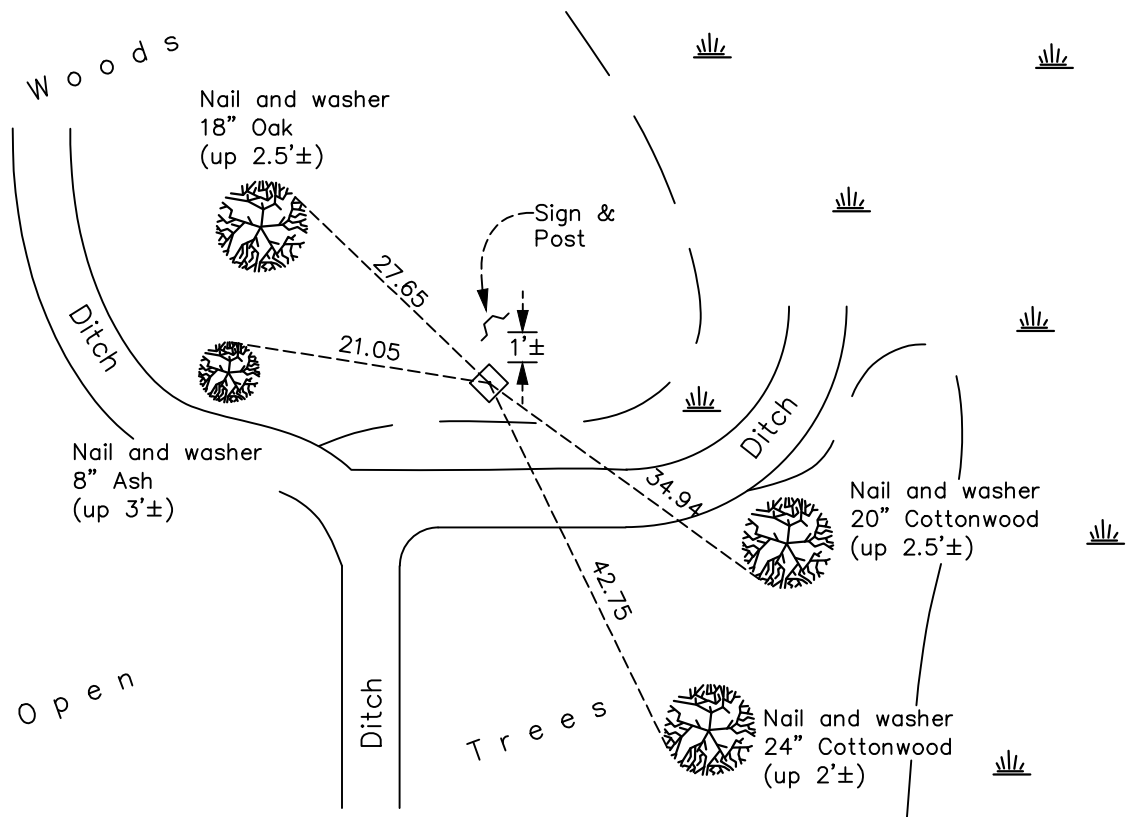

Revision Date
3/28/2024

N.A.D. 1983 Coordinates
 (2022 Adjustment)

County Project Coordinates	
Northing	<u>201461.6640</u>
Easting	<u>463411.2040</u>
Date	<u>2/25/03</u>

I hereby certify that this United States public land survey monument record is correct and complete to the best of my knowledge and belief.

David Zieglsmeier Date 3/28/24

David M. Zieglsmeier, Anoka County Surveyor
 Minnesota License Number 46179

HISTORY OF GOVERNMENT CORNER

Page No. 100

County of Anoka

State of Minnesota

Southwest Corner of Sec. 25 Township 33 Range 25

CORNER HISTORY:

May 1855 - This corner was established by James M. Marsh, Deputy Surveyor. Marsh marked the position by "set post corner of sections 25, 26, 35 and 36" with two bearing trees marked as accessories.

July 12, 1960 - Found granite monument up 1'± and updated ties.

8/17/1965, 7/25/69, 8/10/73, 7/29/1976, 7/25/1979, 8/9/1982 - Found granite monument under east & west fence, up 1'± and updated ties.

9/8/1988, 7/20/1994 - Found granite monument w/sign and post on the north side. Updated ties.

February 25, 2003 - Established NAD 1983 (1996 adj.) Anoka County project coordinates by static GPS methods. N = 201461.6640 E = 463411.2040

October 28, 2013 - Found granite monument up 0.8'± and leaning 0.2'± easterly. Updated ties.

March 27, 2018 - Found granite monument up 0.8'± and leaning 0.4'± easterly. Updated ties.

July 21, 2021 - Found granite monument up 0.8'± and leaning 0.4'± easterly. Updated ties. Verified position of corner by VRS GPS method.

February 15, 2024 - Found 6" x 6" Granite up 0.8'± and leaning 0.4'± easterly with chiseled 'X' . Adjusted same granite, straightening, set up 0.6'±. Set to published coordinates using RTK GPS method and historic ties. Updated ties after setting. Sign and post found to north, 1'±, facing southeast. Job #24-100