

S $\frac{1}{16}$ Cor. of NE $\frac{1}{4}$ of Sec. 5-T33-R24Found 1 $\frac{1}{4}$ " Iron Pipe up 0.5'±.

Leaning SW approx. 0.1'±.

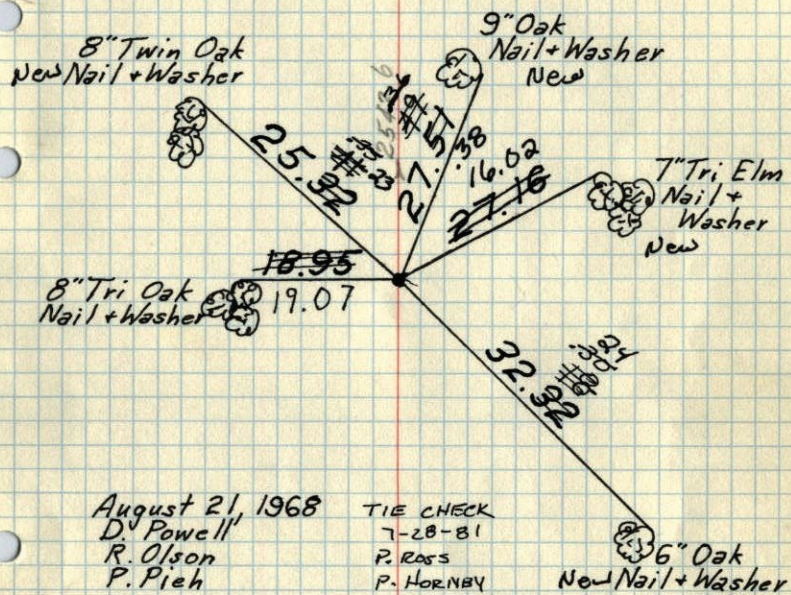

August 21, 1968
D. Powell
R. Olson
P. Pieh

TIE CHECK
7-28-81
P. ROSS
P. HORNBY
G. NEFFINGER

Tie Check
June 26, 1975
D. Dahl,
B. S.
G. A.

TIE CHECK
6-26-78
D. DAHL
M. KISEDOW
B. STEPHENS

TEMPERATURE CORRECTED
AND HORIZONTALLY
TAPED MEASUREMENTS

ROLAND W. ANDERSON
COUNTY SURVEYOR
ANOKA COUNTY, MINNESOTA

S $\frac{1}{16}$ Cor. of NE $\frac{1}{4}$ of Sec. 5-T33-R24Found 1 $\frac{1}{4}$ " Iron Pipe up 0.5'±.

Leaning SW ~ 0.1'±.

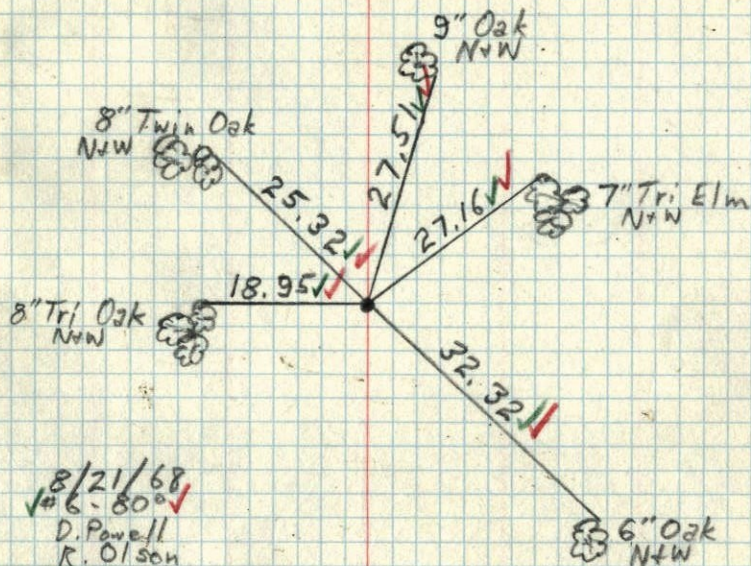

8/21/68
6-80°
D. Powell
R. Olson
P. Pieh

TEMPERATURE CORRECTED
AND HORIZONTALLY
TAPED MEASUREMENTS

ROLAND W. ANDERSON
COUNTY SURVEYOR
ANOKA COUNTY, MINNESOTA

3/4/58

Co. Hwy. Dept.

S/16 Corn. of NE 1/4 of Sec. 5

T 33, R 24

Ties from H.E. Blawett's notes
of 8-9-22

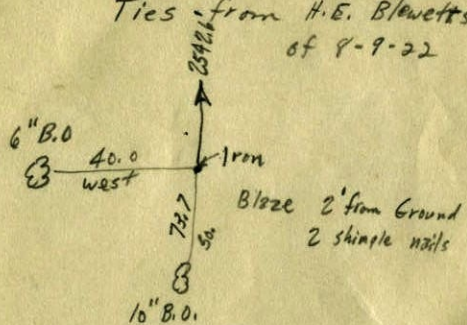

✓ 3/4/58

Co. Hwy. Dept.

S/16 Corn. of NE 1/4 of Sec. 5

T 33, R 24

Ties from H.E. Blawett's notes
of 8-9-22

