

CERTIFICATE OF LOCATION OF GOVERNMENT CORNER

County of Anoka

State of Minnesota

East 1/4 Corner of Sec. 6 Township 33 Range 24

On the 5th day of December, 1967, the described corner was evidenced by area resurvey

and to perpetuate the location of said corner, at the exact location thereof, a permanent marker was placed consisting of a cast iron monument with a sign and post on the north side

AND on the 4th day of December, 2020, said permanent marker was found up 0.4'± and the ties were updated

Updated reference ties are as shown below.

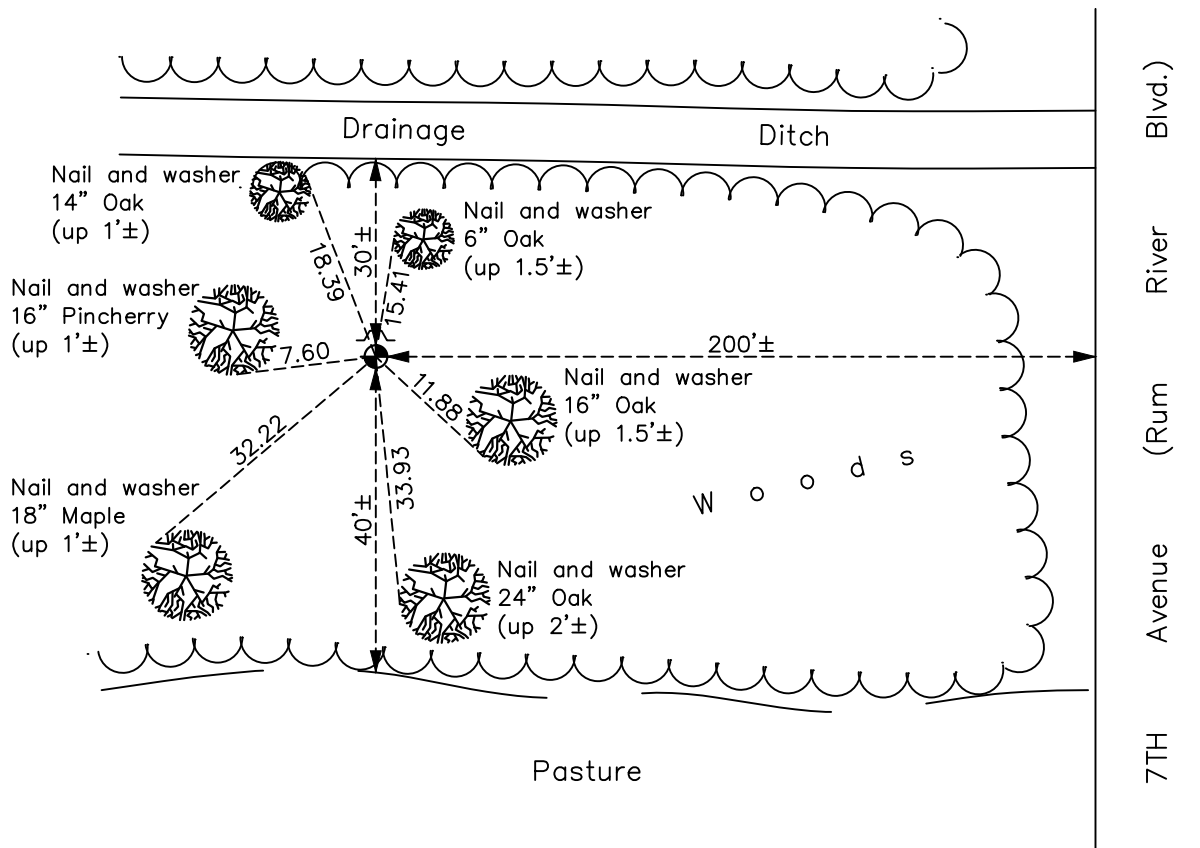

Revision Date

01/14/2021

N.A.D. 1983 Coordinates
(1996 Adjustment)

County Project Coordinates	
Northing	224952.8508
Easting	473984.2050
Date	3/29/01

I hereby certify that this United States public land survey monument record is correct and complete to the best of my knowledge and belief.

David M Zieglmeier Date 7/29/21

David Zieglmeier Anoka County Surveyor
Minnesota License Number 46179

HISTORY OF GOVERNMENT CORNER

Page No. 15

County of Anoka

State of Minnesota

East 1/4 Corner of Sec. 6 Township 33 Range 24

CORNER HISTORY:

December 5, 1967 - Set cast iron monument flush using area resurvey. Established ties to monument.

June 21, 1968 - Found cast iron monument and updated ties.

July 29, 1971 - Found cast iron monument and updated ties.

June 26, 1975 - Found cast iron monument and updated ties.

June 26, 1978 - Found cast iron monument and updated ties.

July 24, 1981 - Found cast iron monument and updated ties.

August 10, 1984 - Found cast iron monument and updated ties.

July 24, 1987 - Found cast iron monument and updated ties.

July 6, 1992 - Found cast iron monument and updated ties.

June 30, 1997 - Found cast iron monument and updated ties.

March 29, 2001 - Found cast iron monument and updated ties. Established NAD 1983 (1996 adj.) Anoka County project coordinates by static GPS methods.

January 5, 2012 - Found cast iron monument up 0.4'± and updated ties.

April 11, 2017 - Found cast iron monument up 0.4'± and updated ties.

December 4, 2020 - Found cast iron monument up 0.4'± and updated ties.