

CERTIFICATE OF LOCATION OF GOVERNMENT CORNER

County of Anoka

State of Minnesota

East 1/4 Corner of Sec. 10 Township 33 Range 24

On the 26th day of November, 1963, the described corner was evidenced by a 4" square concrete monument

and to perpetuate the location of said corner, at the exact location thereof, a permanent marker was placed consisting of a 2" square steel Telespar monument with "County Surveyor" cap and punchmark

AND on the 28th day of December, 2020, said permanent marker was found with a sign and post on the north side and the ties were updated

Updated reference ties are as shown below.

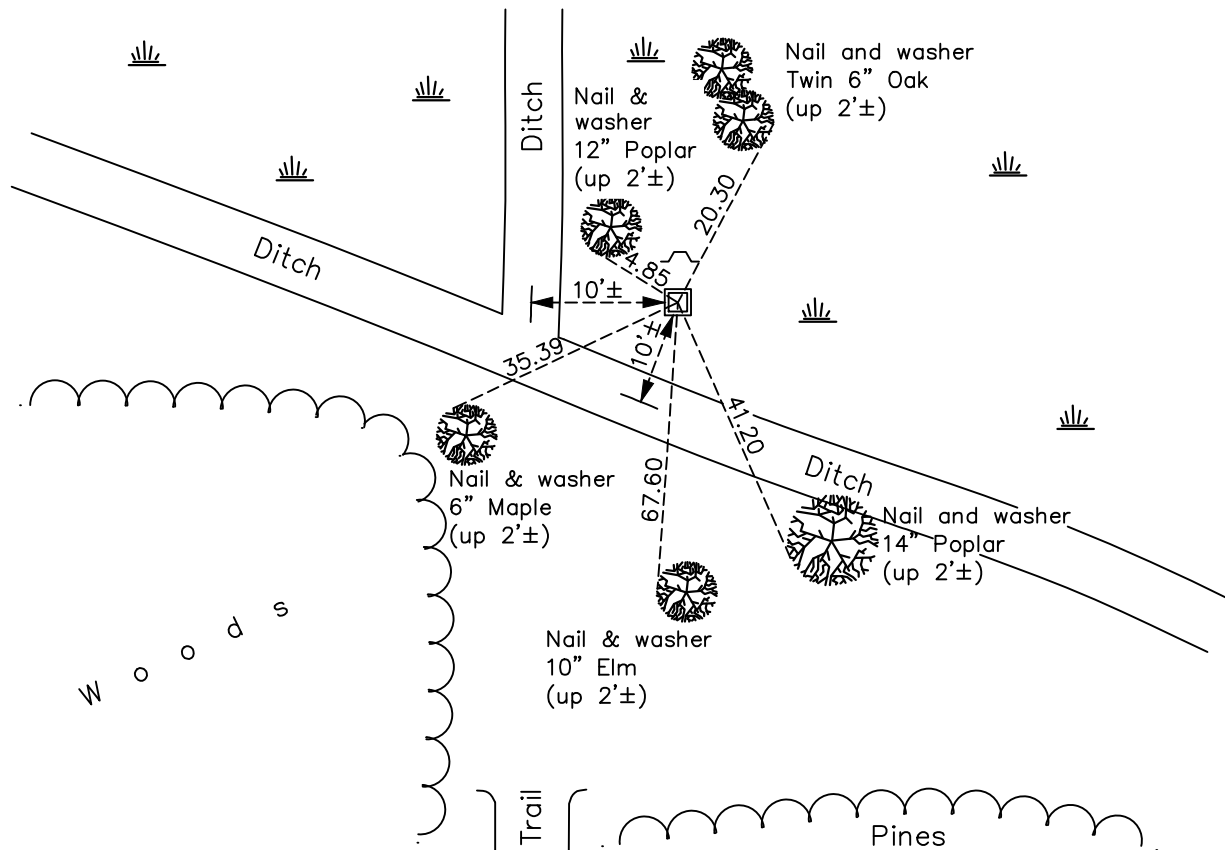

ANOKA COUNTY SURVEYOR

Revision Date

05/24/2021

N.A.D. 1983 Coordinates
(1996 Adjustment)

County Project Coordinates	
Northing	219547.0572
Easting	489704.8654
Date	11/08/01

I hereby certify that this United States public land survey monument record is correct and complete to the best of my knowledge and belief.

David M Zieglmeier Date 7/29/21

David Zieglmeier Anoka County Surveyor
Minnesota License Number 46179

HISTORY OF GOVERNMENT CORNER

Page No. 42

County of Anoka

State of Minnesota

East 1/4 Corner of Sec. 10 Township 33 Range 24

CORNER HISTORY:

December 20, 1944 - Harvey Cartwright set a concrete monument using old North/South fence line and on extended fence line from the East good line to 125' East grown in 50 years growth. Established ties to concrete monument.

November 26, 1963 - Found 4" square concrete monument up 0.3'±. Updated ties.

June 27, 1968 - Found concrete monument and updated ties.

June 30, 1975 - Found concrete monument and updated ties.

June 30, 1978 - Found concrete monument and updated ties.

July 21, 1987 - Found concrete monument and updated ties.

June 17, 1997 - Found concrete monument and updated ties.

November 8, 2001 - Found concrete monument up 1.5'± and updated ties. Established NAD 1983 (1996 adj.) Anoka County project coordinates by static GPS methods.

September 12, 2011 - Found concrete monument up 1.5'± and in need of lowering. Checked corner ties.

May 2, 2012 - Removed concrete monument and replaced with a 2" square by 6" steel Telspar monument with punch marked cap using static GPS methods. Verified position by VRS GPS methods and updated ties to Telspar monument. Sign and post was set on the north side 4/2/2012.

April 3, 2017 - Found 2" square steel Telspar monument w/punch marked cap and a sign and post on the north side. Updated ties.

December 28, 2020 - Found 2" square steel Telspar monument w/punch marked cap and a sign and post on the north side. Updated ties.