

CERTIFICATE OF LOCATION OF GOVERNMENT CORNER

County of Anoka

State of Minnesota

Witness Corner of Sec. 17 Township 33 Range 24
(on north line of section)

On the 27th day of June, 1968, the described corner was evidenced by a pinched
1 1/2" iron pipe

and to perpetuate the location of said corner, at the exact location thereof, a permanent marker was placed consisting of a cast iron monument

AND on the 5th day of July, 2023, said permanent marker was found down 1'± and
the ties were updated

Updated reference ties are as shown below.

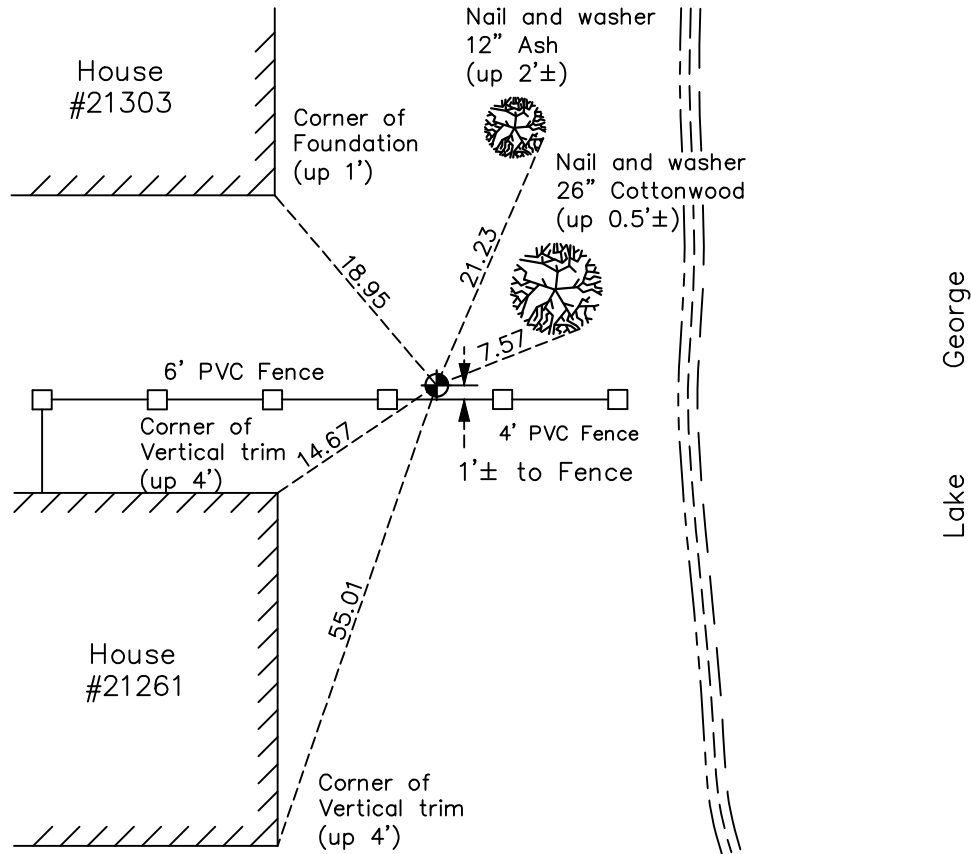

Revision Date
10/05/2023

N.A.D. 1983 Coordinates
(1996 Adjustment)

County Project Coordinates	
Northing	<u>216996.4493</u>
Easting	<u>479050.6193</u>
Date	<u>5/10/01</u>

I hereby certify that this United States public land survey monument record is correct and complete to the best of my knowledge and belief.
David Zieglmeier Date 3/29/24
 David Zieglmeier Anoka County Surveyor
 Minnesota License Number 46179

HISTORY OF GOVERNMENT CORNER

Page No. 55

County of Anoka

State of Minnesota

Witness Corner of Sec. 17 Township 33 Range 24
(on north line of section)

CORNER HISTORY:

September 16, 1964 - Found 1-1/2" pinched iron pipe up 0.3'± and updated ties.

July 19, 1965 - Found 1-1/2" pinched iron pipe up 0.3'± and updated ties.

June 27, 1968 - Found 1-1/2" pinched iron pipe and replaced with a cast iron monument flush. Updated ties.

July 28, 1971 - Found cast iron monument and updated ties.

July 2, 1975 - Found cast iron monument and updated ties.

July 5, 1978 - Found cast iron monument and updated ties.

July 31, 1981 - Found cast iron monument and updated ties.

August 3, 1984 - Found cast iron monument and updated ties.

July 8, 1992 - Found cast iron monument and updated ties.

June 19, 1997 - Found cast iron monument and updated ties.

May 10, 2001 - Found cast iron monument and updated ties. Established NAD 1983 (1996 adj.) Anoka County project coordinates by static GPS methods.

December 2, 2011 - Found cast iron monument and updated ties.

April 12, 2017 - Found cast iron monument down 1'± and 1'± North of fence line. Updated ties.

April 16, 2021 - Found cast iron monument down 1'± and 1'± North of fence line. Verified position by VRS GPS methods. Updated ties.

July 5, 2023 - Found cast iron monument down 1'± and 1'± North of fence line. Verified position by ACS RTK GPS method and updated the ties. (tape)