

CERTIFICATE OF LOCATION OF GOVERNMENT CORNER

County of Anoka

State of Minnesota

East 1/4 Corner of Sec. 15 Township 33 Range 24

On the 13th day of February, 2024, the described corner was evidenced by a red & white
iron pipe

and to perpetuate the location of said corner, at the exact location thereof, a permanent marker was placed consisting of a 2"x 2"x 6' Telspar w/ aluminum cap and punch mark, set up 0.8'± in
same location replacing found iron pipe, which was removed.

AND on the 13th day of February, 2024, said permanent marker was measured with RTK GPS
method to verify location and ties were updated after setting.

Updated reference ties are as shown below.

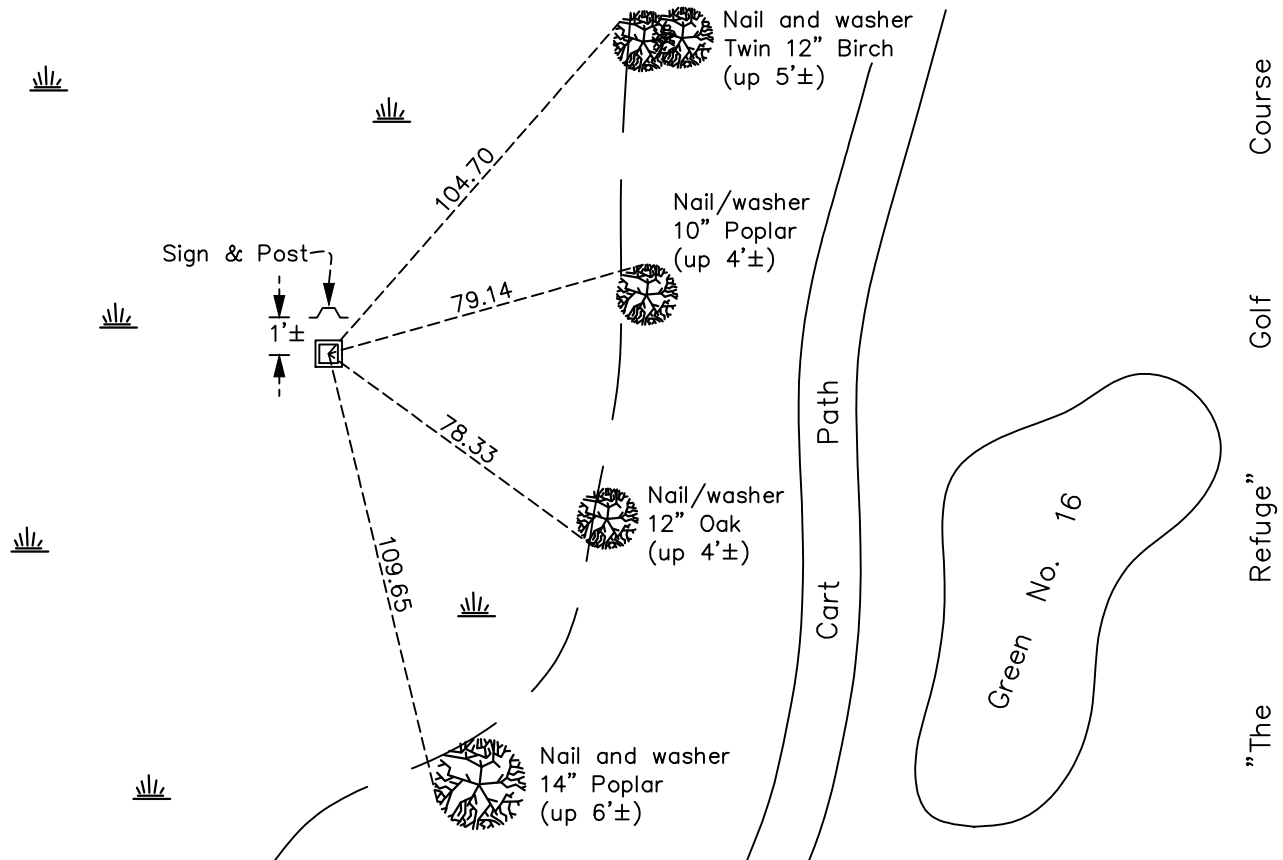

Revision Date
3/27/2024

N.A.D. 1983 Coordinates
(1996 Adjustment)

County Project Coordinates	
Northing	<u>214254.5882</u>
Easting	<u>489691.5998</u>
Date	<u>2/20/02</u>

I hereby certify that this United States public land survey monument record is correct and complete to the best of my knowledge and belief.
David Zieglmeier Date 3/28/24
David Zieglmeier Anoka County Surveyor
Minnesota License Number 46179

HISTORY OF GOVERNMENT CORNER

Page No. 67

County of Anoka

State of Minnesota

East 1/4 Corner of Sec. 15 Township 33 Range 24

CORNER HISTORY:

May 1855 - This corner was established by James M. Marsh, Deputy Surveyor. Marsh marked this position by "set quarter section post" with one bearing tree marked as an accessory.

March 19, 1973 - Set red and white iron pipe w/sign using area resurvey. Established ties to iron pipe.

June 29, 1979 - Found red and white iron pipe standing but loose. Updated ties.

June 23, 1997 - Found red and white iron pipe and updated ties.

February 20, 2002 - Found red and white iron pipe and updated ties. Established NAD 1983 (1996 adj.) Anoka County project coordinates by static GPS methods.

December 2, 2011 - Found red and white iron pipe w/broken sign and an iron pipe next to it up 6.5'±. Updated ties to red and white iron pipe. Replaced broken sign on 4/6/2012.

2/20/18, 12/2/20 - Found red and white iron pipe up 3'± w/sign attached. Verified position by VRS GPS methods. Updated ties.

February 13, 2024 - Found iron pipe up 3'± with sign attached; removed. Replaced with 2"x 2"x 6' Telspar with 'county surveyor' cap and punch mark, set up 0.8'±. Set to published coordinates using RTK GPS method and historical ties. Updated ties after setting. Added sign and post to north side, facing south. Job #24-100