

CERTIFICATE OF LOCATION OF GOVERNMENT CORNER

County of Anoka

State of Minnesota

South 1/4 Corner of Sec. 13 Township 33 Range 24

On the 31st day of August, 1970, the described corner was evidenced by area resurvey

and to perpetuate the location of said corner, at the exact location thereof, a permanent marker was placed consisting of 2" x 12' square Telspar monument with punched 'county surveyor' cap with a sign and post on the South side

AND on the 5th day of December, 2022, said permanent marker was found 2" square Telspar monument up 1.5'± with punched 'county surveyor' cap and updated ties.

Updated reference ties are as shown below.

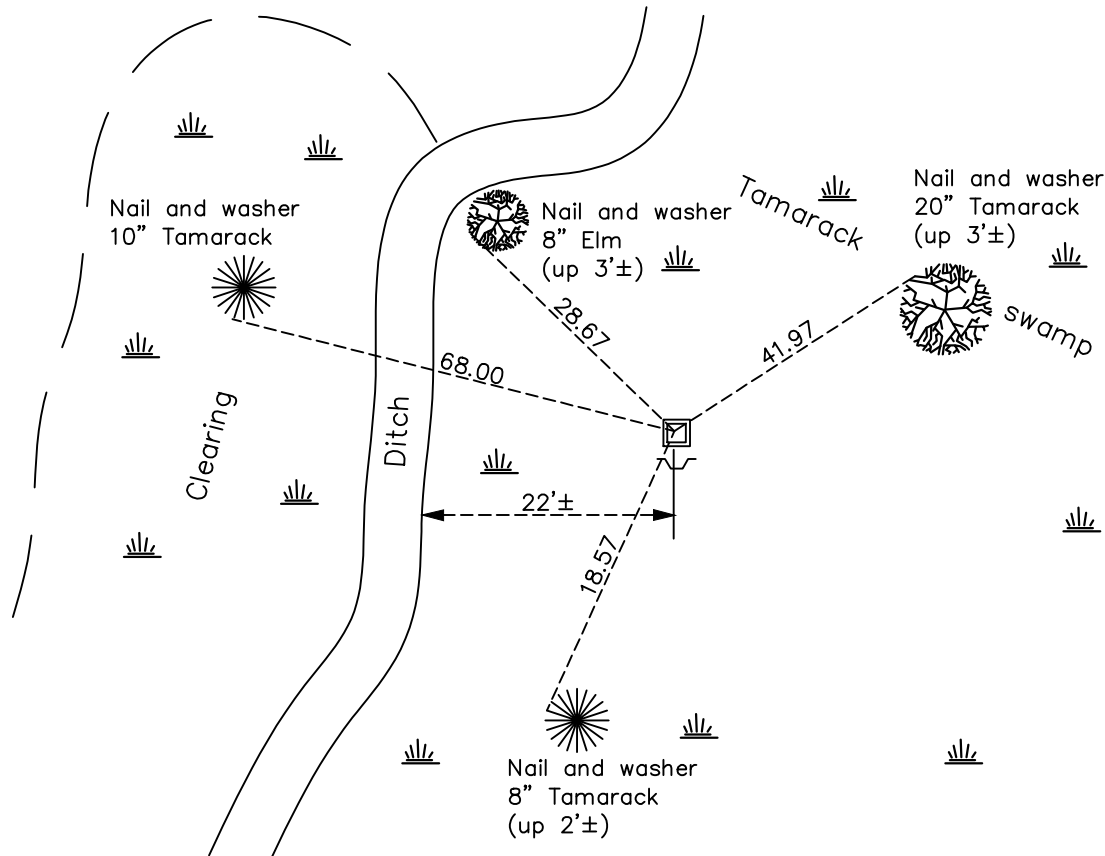

Revision Date

12/06/2022

N.A.D. 1983 Coordinates
(1996 Adjustment)

County Project Coordinates	
Northing	<u>211659.4008</u>
Easting	<u>497603.3359</u>
Date	<u>2/20/02</u>

I hereby certify that this United States public land survey monument record is correct and complete to the best of my knowledge and belief.

David Zieglmeier Date 6/28/23

David Zieglmeier Anoka County Surveyor
Minnesota License Number 46179

HISTORY OF GOVERNMENT CORNER

Page No. XX

County of Anoka

State of Minnesota

South 1/4 Corner of Sec. 13 Township 33 Range 24

CORNER HISTORY:

Date:

August 31, 1970 - Set Red & White Iron Pipe up 4'± from area resurvey and set ties

August 31, 1970 - Found Red & White Iron Pipe up 4' ± and updated ties

March 21, 1988 - Found Red & White Iron Pipe up 2'± and updated ties

February 20, 2002 - Found Red & White Iron Pipe up 2'± and updated ties

February 23, 2018 - Replaced red & white iron pipe found up 3'± and leaning with 2" x 12' Telspar monument set up 1'± w/ punched cap. Set sign & post on South side and updated ties.

December 5, 2022 - Found 2" square Telspar monument with punched cap up 1.5'±, verified position by VRS GPS method and updated ties.