

CERTIFICATE OF LOCATION OF GOVERNMENT CORNER

County of Anoka

State of Minnesota

East 1/4 Corner of Sec. 31 Township 33 Range 24

On the 1st day of November, 1984, the described corner was evidenced by area resurvey

and to perpetuate the location of said corner, at the exact location thereof, a permanent marker was placed consisting of a cast iron monument

AND on the 11th day of December, 2020, said permanent marker was found down 0.5'± and ties were updated. Monument is 1/2 mile west of Cedar Creek Conservation Area entrance gate.

Updated reference ties are as shown below.

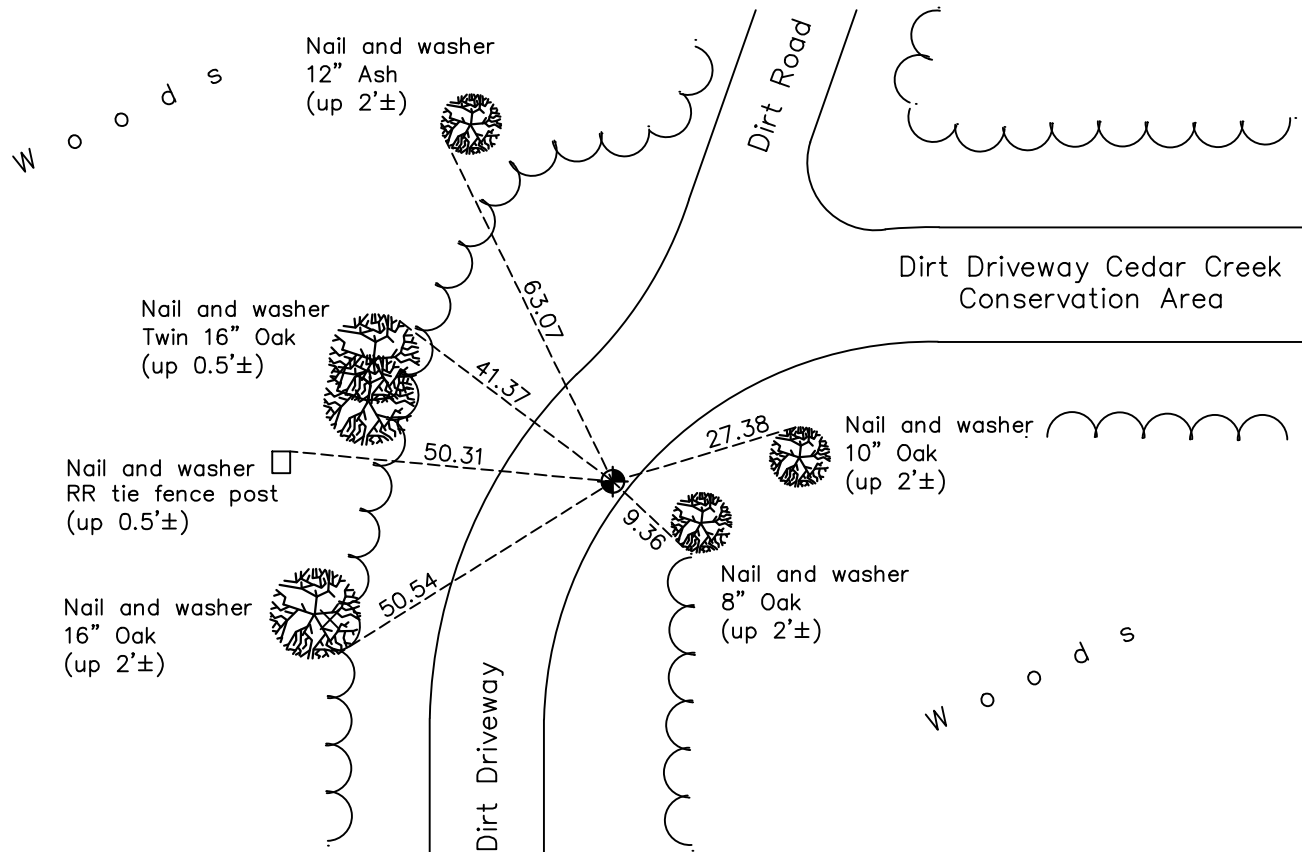

Revision Date

07/06/2021

N.A.D. 1983 Coordinates
(1996 Adjustment)

County Project Coordinates	
Northing	<u>198642.5404</u>
Easting	<u>474025.4765</u>
Date	<u>6/12/02</u>

I hereby certify that this United States public land survey monument record is correct and complete to the best of my knowledge and belief.

David M Zieglmeier Date 7/30/21

David Zieglmeier Anoka County Surveyor
Minnesota License Number 46179

HISTORY OF GOVERNMENT CORNER

Page No. 122

County of Anoka

State of Minnesota

East 1/4 Corner of Sec. 31 Township 33 Range 24

CORNER HISTORY:

1963 - N.C. Hoium found a iron pipe and updated ties.

August 2, 1973 - Reset corner using remaining ties. Set 2 cast iron monuments one on top of the other due to the area residents habit of removing corners. Updated ties. Set warning sign and post.

November 1, 1984 - Reset cast iron monument down 1'± using area resurvey. Updated ties.

June 12, 2002 - Established NAD 1983 (1996 adj.) Anoka County project coordinates by static GPS methods.

February 22, 2012 - Found cast iron monument down 0.5'± and updated ties.

April 10, 2017 - Found cast iron monument down 0.5'± and updated ties.

December 11, 2020 - Found cast iron monument down 0.5'±. Verified position by VRS GPS methods. Updated ties.