

# CERTIFICATE OF LOCATION OF GOVERNMENT CORNER

County of Anoka

State of Minnesota

## Northwest Corner of Sec. 23 Township 32 Range 25

On the 27th day of April, 1961, the described corner was evidenced by a 1/2" iron pipe

and to perpetuate the location of said corner, at the exact location thereof, a permanent marker was placed consisting of a cast iron monument

AND on the 30th day of September, 2022, said permanent marker was found flush with a sign and post on the north side and the ties were updated

Updated reference ties are as shown below.

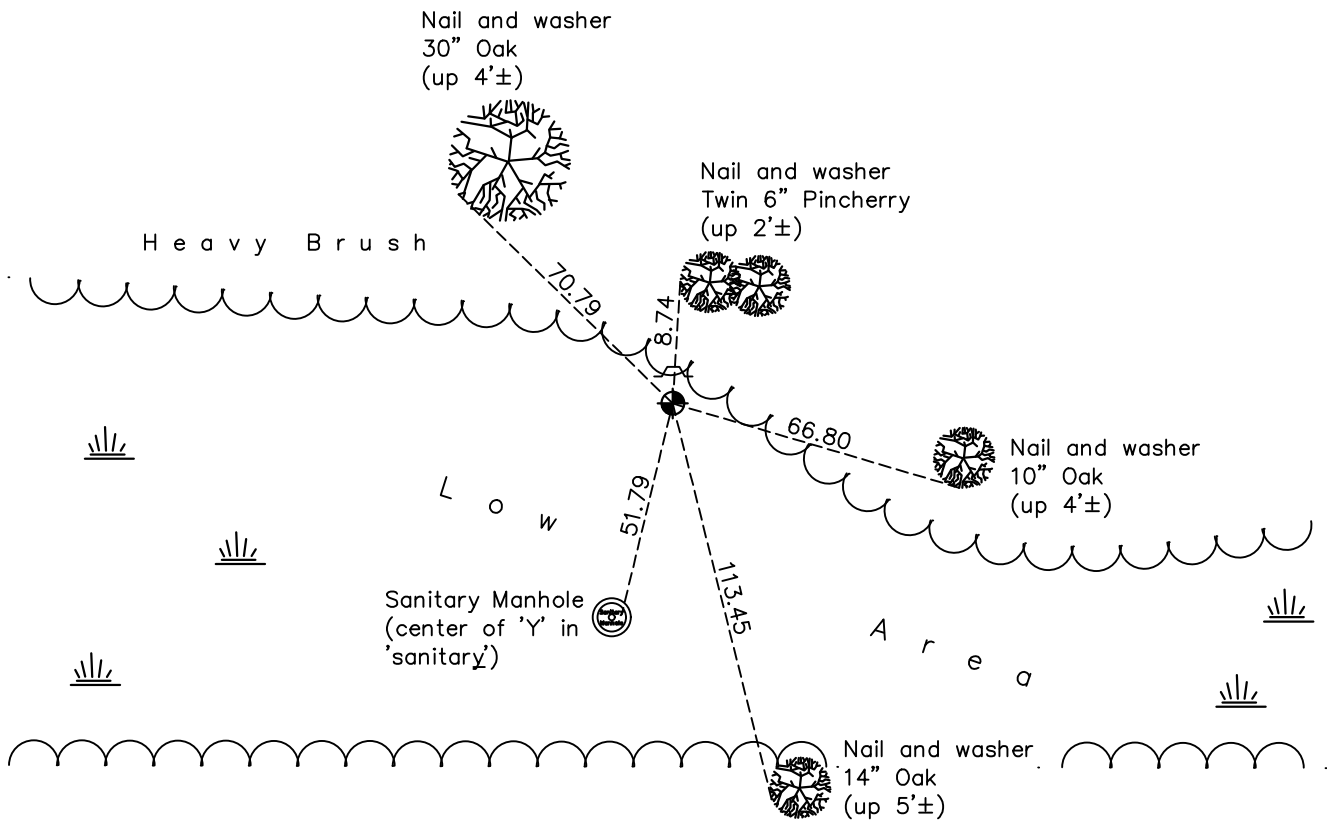

Revision Date  
1/4/23

N.A.D. 1983 Coordinates  
 (1996 Adjustment)

County Project Coordinates	
Northing	<u>180388.3267</u>
Easting	<u>458070.9755</u>
Date	<u>4/18/00</u>

I hereby certify that this United States public land survey monument record is correct and complete to the best of my knowledge and belief.

*David Zieglmeier* Date 2/22/23

David Zieglmeier Anoka County Surveyor  
 Minnesota License Number 46179

# HISTORY OF GOVERNMENT CORNER

Page No. 73

County of Anoka

State of Minnesota

## Northwest Corner of Sec. 23 Township 32 Range 25

### **CORNER HISTORY:**

September 25, 1959 – Ray Prasch from Cartwright and Olson set iron pipe using area resurvey, possible bearing tree and fences. Established ties to monument.

April 27, 1961 – Replaced 1/2" iron pipe found with a cast iron monument set flush with the surface. Updated ties.

August 6, 1964 – Found cast iron monument and updated ties.

June 19, 1969 – Found cast iron monument up 0.1'± and updated ties.

August 18, 1972 – Found cast iron monument and updated ties.

July 1, 1976 – Found cast iron monument and updated ties.

June 21, 1979 – Found cast iron monument and updated ties.

August 18, 1982 – Found cast iron monument and updated ties.

July 29, 1985 – Found cast iron monument and updated ties.

July 11, 1988 – Found cast iron monument and updated ties.

August 16, 1993 – Found cast iron monument and updated ties.

April 18, 2000 – Found cast iron monument with a sign and post on the north side and established NAD 1983 (1996 Adjustment) Anoka County Project Coordinates by Static GPS methods. Updated ties.

April 2010 – Found cast iron monument up 0.2'± with a sign and post on the north side and updated ties.

October 13, 2015 – Found cast iron monument flush with the surface with a sign and post on the north side and updated ties.

April 24, 2020 – Found cast iron monument flush with the surface with a sign and post on the north side and updated ties.

September 30, 2022 – Found cast iron monument flush with the surface with a sign and post on the north side and updated ties. Verified location of corner by VRS GPS methods.