

# CERTIFICATE OF LOCATION OF GOVERNMENT CORNER

County of Anoka

State of Minnesota

## Northwest Corner of Sec. 34 Township 32 Range 25

On the 17th day of April, 1962, the described corner was evidenced by a 3/4" iron pipe

and to perpetuate the location of said corner, at the exact location thereof, a permanent marker was placed consisting of a P.K. nail

AND on the 21st day of April, 2010, said permanent marker was not found. The corner will be set at a later date.

Updated reference ties are as shown below.

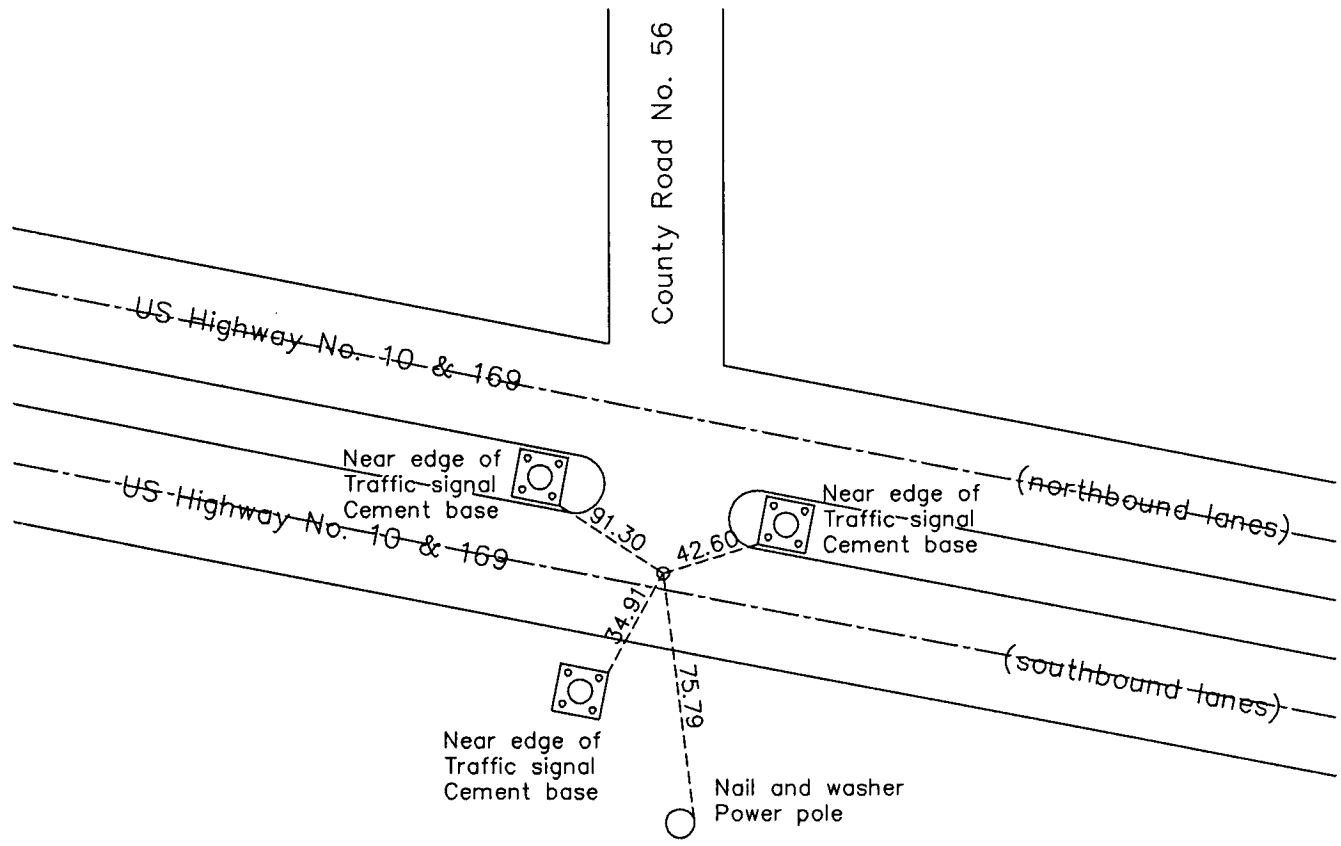

ANOKA COUNTY SURVEYOR

Revision Date

8/09/10

N.A.D. 1983 Coordinates  
(1996 Adjustment)

County Project Coordinates	
Northing	169815.4937
Easting	452836.0148
Date	11/29/00

I hereby certify that this United States public land survey monument record is correct and complete to the best of my knowledge and belief.

*Larry D. Hoium* Date 8/09/10

Larry D. Hoium, Anoka County Surveyor

Minnesota License Number 18165

# HISTORY OF GOVERNMENT CORNER

Page No. 119

County of Anoka

State of Minnesota

## Northwest Corner of Sec. 34 Township 32 Range 25

### **CORNER HISTORY:**

May 10, 1944 - Cartwright found concrete monument and established ties to monument.

September 11, 1957 - Cartwright and Olson set 3/4" X 2' iron pipe flush with the bituminous surface and updated ties.

April 17, 1962 - Found 3/4" iron pipe down 0.05'± in centerline of southbound lane and updated ties.

August 26, 1969 - Replaced iron pipe down 0.5'± with a cast iron monument set flush with the surface. Set P.K. nails 2.00' north and west and updated ties.

August 4, 1972 - Found cast iron monument and updated ties.

July 8, 1976 - Found cast iron monument and updated ties.

June 26, 1979 - Found cast iron monument and updated ties.

August 19, 1982 - Found cast iron monument and updated ties.

July 17, 1985 - Found cast iron monument flush with the surface and updated ties.

June 28, 1988 - Found cast iron monument and updated ties.

August 10, 1993 - Found cast iron monument and updated ties.

November 29, 2000 - Found P.K. nail and established NAD 1983 (1996 Adjustment) Anoka County Project Coordinates by Static GPS methods. Updated ties.

April 21, 2010 - Found P.K. nail missing. Corner needs to be reset.