

# CERTIFICATE OF LOCATION OF GOVERNMENT CORNER

County of Anoka

State of Minnesota

## West 1/4 Corner of Sec. 35 Township 34 Range 24

On the 31st day of December, 1977, the described corner was evidenced by area resurvey

and to perpetuate the location of said corner, at the exact location thereof, a permanent marker was placed consisting of a red and white 2" square steel Telspar monument

AND on the 17th day of November, 2022, said permanent marker was found up 4'± leaning South with sign attached facing East, Straightened Telspar and then updated the ties

Updated reference ties are as shown below.

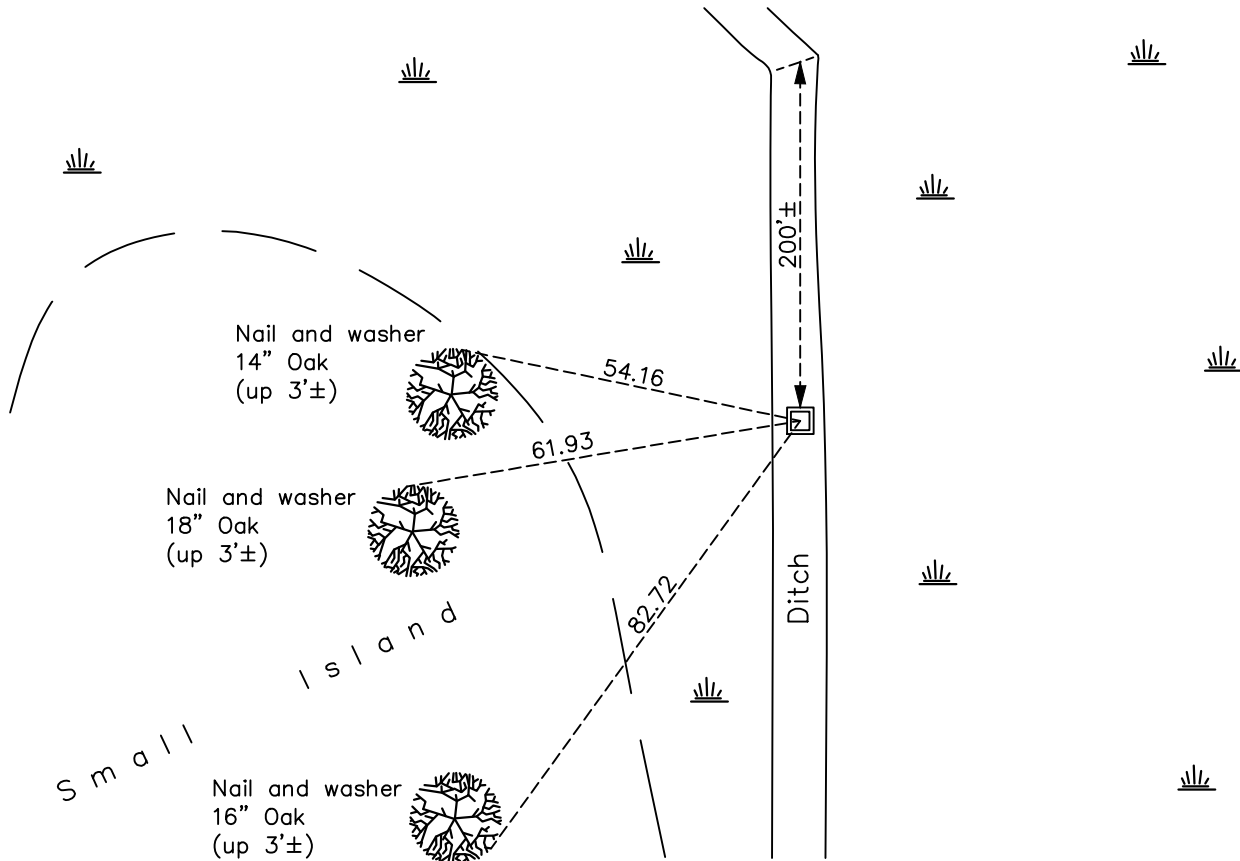

Revision Date  
 1/31/2023

N.A.D. 1983 Coordinates  
 (1996 Adjustment)

County Project Coordinates	
Northing	<u>230052.4257</u>
Easting	<u>489812.5242</u>
Date	<u>4/15/03</u>

I hereby certify that this United States public land survey monument record is correct and complete to the best of my knowledge and belief.  
*David Zieglmeier* Date 3/1/23  
 David Zieglmeier Anoka County Surveyor  
 Minnesota License Number 46179

# HISTORY OF GOVERNMENT CORNER

Page No. 42

County of Anoka

State of Minnesota

## West 1/4 Corner of Sec. 35 Township 34 Range 24

### **CORNER HISTORY:**

December 31, 1977 - Set red and white iron pipe up 3'± in center of ditch using area resurvey. Established ties to iron pipe.

February 8, 1995 - Replaced red and white iron pipe and updated ties.

April 15, 2003 - Found red and white iron pipe w/sign attached and updated ties. Established NAD 1983 (1996 adj.) Anoka County project coordinates by static GPS methods.

March 25, 2014 - Found 2" red and white square steel telspar monument up 4'± and leaning south 0.5'±. Updated ties.

January 5, 2021 - Found 2" red and white square steel Telspar monument up 4'± and leaning south 0.5'±. Updated ties.

November 17, 2022 - Found 2" red and white square steel Telspar monument up 4'±, leaning South. Straightened monument then verified position by VRS GPS method and updated the ties.