

CERTIFICATE OF LOCATION OF GOVERNMENT CORNER

County of Anoka

State of Minnesota

Northwest Corner of Sec. 35 Township 34 Range 25

On the 18th day of September, 2014, the described corner was evidenced by a cast iron monument

and to perpetuate the location of said corner, at the exact location thereof, a permanent marker was placed consisting of a 2"x2"x7' steel Telspar monument w/"Co. Surveyor" punch marked cap

AND on the 14th day of November, 2022, said permanent marker was found up 1.5'± and the ties were updated

Updated reference ties are as shown below.

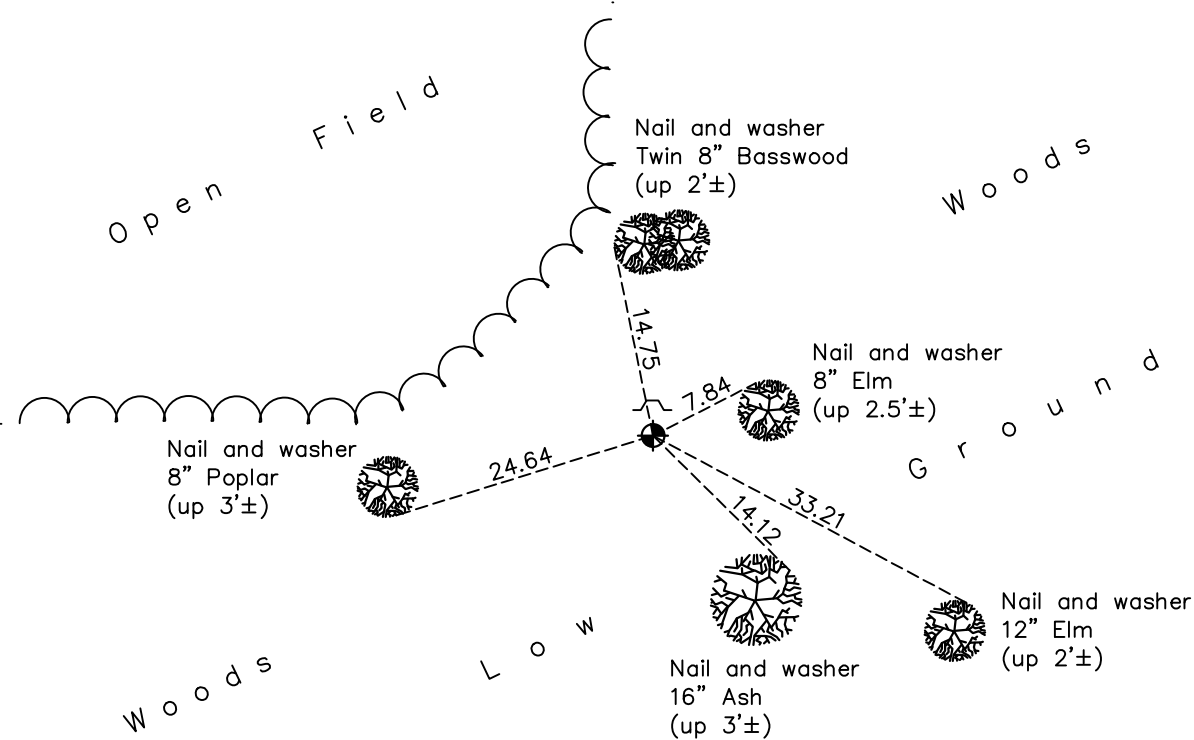

Revision Date

2/01/2023

N.A.D. 1983 Coordinates
(1996 Adjustment)

County Project Coordinates

Northing 232779.2241

Easting 458154.1753

Date 5/01/03

I hereby certify that this United States public land survey monument record is correct and complete to the best of my knowledge and belief.

David Zieglmeier Date 3/1/23

David Zieglmeier Anoka County Surveyor

Minnesota License Number 46179

HISTORY OF GOVERNMENT CORNER

Page No. 69

County of Anoka

State of Minnesota

Northwest Corner of Sec. 35 Township 34 Range 25

CORNER HISTORY:

October 6, 1970 - Set cast iron monument flush using area resurvey. Established ties to monument.

June 17, 1974 - Found cast iron monument and updated ties.

August 11, 1976 - Set sign and post on the north side.

May 9, 1977 - Found cast iron monument and updated ties.

August 27, 1980 - Found cast iron monument and updated ties.

August 1, 1984 - Found cast iron monument and updated ties.

July 28, 1992 - Found cast iron monument and updated ties.

July 22, 1997 - Found cast iron monument and updated ties.

April 30, 2003 - Found cast iron monument and updated ties.

May 1, 2003 - Established NAD 1983 (1996 adj.) Anoka County project coordinates by static GPS methods.

April 11, 2014 - Found cast iron monument up 0.5'± and leaning easterly. Checked position using corner ties.

September 18, 2014 - Replaced leaning cast iron with a 2"x2"x7' steel Telspar monument w/"Co. Surveyor" punch marked cap using static GPS methods. Updated ties.

September 21, 2020 - Found 2" square steel Telspar monument w/punch marked cap up 1.5'±. Updated ties.

November 14, 2022 - Found 2" square steel Telspar monument w/ punch marked cap up 1.5'±, verified position of monument by VRS GPS method and the ties were updated.