

MISSISSIPPI WEST REGIONAL PARK

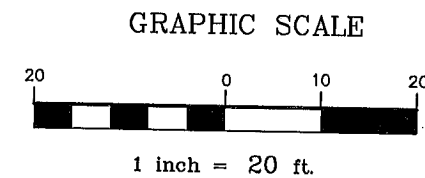
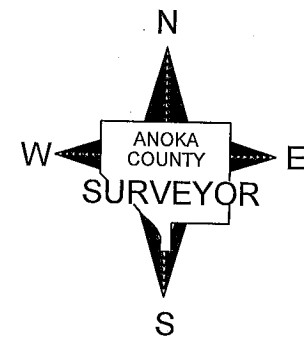
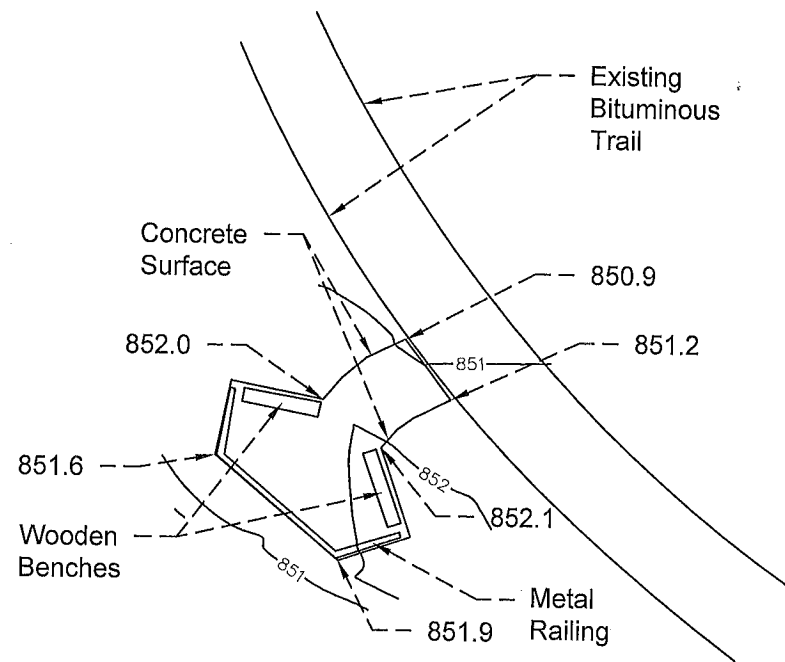

I hereby certify that this survey, plan or report was prepared by me or under my direct supervision and that I am a duly Licensed Land Surveyor under the laws of the State of Minnesota.

Larry D. Hoium
 LARRY D. HOIUM

Date Nov. 13, 2012 License No. 18165

ANOKA COUNTY SURVEYOR'S OFFICE	
2100 3RD AVENUE NORTH, ROOM 224 ANOKA, MN. 55303 763-323-5511	
OVERLOOK AS-BUILT SURVEY for ANOKA COUNTY PARKS DEPARTMENT	
DATE : November 9, 2012	SHEET 1 OF 1 SHEET