

L=19.16 Measured
L=19.26 Plat
R=55.39 Plat & Measured
Δ=19°49'06" Measured
Δ=19°55'34" Plat
C. Brg.=N09°00'08"W

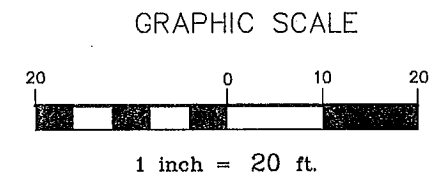
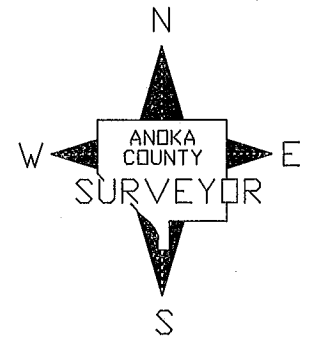

Bearing System Is Assumed.

● Denotes Found Iron Monument.

Lot 3, Block 1, OAKS OF SHENANDOAH
9TH ADDITION, Anoka County, Minnesota.
P.I.N. 03-31-24-12-0012

I hereby certify that this survey, plan or report was prepared by me or under my direct supervision and that I am a duly Licensed Land Surveyor under the laws of the State of Minnesota.

Larry D. Houim
LARRY D. HOIUM

Date JUNE 7, 2010 License No. 18165

| | |
|--|--------------------|
| ANOKA COUNTY SURVEYOR'S OFFICE | |
| 2100 3RD AVENUE NORTH, ROOM 224 ANOKA, MN. 55303 763-323-5511 | |
| BOUNDARY SURVEY for ANOKA COUNTY COMMUNITY DEVELOPMENT | |
| DATE : June 7, 2010 | SHEET 1 OF 1 SHEET |

3019
Original