

103RD AVENUE NW

R=227.98
L=94.72 Measured
L=95.12 Plat
Δ=23°48'16" Measured
Δ=23°54'18" Plat

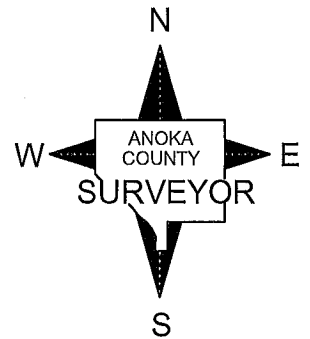

GRAPHIC SCALE

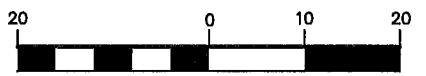

1 inch = 20 ft.

Bearing System Is Assumed.

- Denotes Found Iron Monument.
- Denotes Iron Pipe Set Marked By Anoka Co. Surv.

Lot 13

127.02 Plat 127.65 Measured
N17°59'12"E

Lot 12

1 Story Frame House
100 103rd Avenue NW

12.00 Plat
12.21 Measured
S47°12'36"E

Lot 11

135.00 Plat 135.27 Measured
S42°28'49"W

Lot 12, Block 6, DAILEY'S 9TH ADDITION,
Anoka County, Minnesota.
P.I.N. 24-31-24-41-0101

I hereby certify that this survey, plan or report was prepared by me or under my direct supervision and that I am a duly Licensed Land Surveyor under the laws of the State of Minnesota.

Larry D. Houm
LARRY D. HOUM

Date SEPTEMBER 26, 2014 License No. 18165

ANOKA COUNTY SURVEYOR'S OFFICE	
2100 3RD AVENUE NORTH, ROOM 224 ANOKA, MN. 55303 763-323-5511	
BOUNDARY SURVEY for ANOKA COUNTY COMMUNITY DEVELOPMENT	
DATE : September 26, 2014	SHEET 1 OF 1 SHEET

3028
Original